

USA

PRICE BOOK

 **Nightingale**



OCTOBER 2022

nightingalechairs.com

How to order:

Product information can be found at:
nightingalechairs.com

Placing a Purchase Order

Purchase orders should be submitted to Nightingale's Customer Care via email at **customercare@nightingalechairs.com** or fax at 1-800-637-6784.

When ordering chairs with multiple design or feature options, please indicate your required choice by adding the suffix to the model number. It is the customer's responsibility to ensure correct information is provided on the purchase order and to check the Acknowledgment for accuracy.

At Nightingale, we are committed to delivering comfortable, ergonomic chairs with the highest quality standards and materials. We thank you for your order and the trust you have placed in us. Once your order is processed you will be sent an Acknowledgment for your reference and records.

For any additional concerns or comments please call 1-800-363-8954 for the customer care department.

Quality makes a difference.

OUR WAY

Exceptional products,
durable engineering,
innovative features,
award-winning design,
ethical commitment.

TABLE OF CONTENTS

Numerically by Series Number

Click on a chair series to go to that page.

Terms & Conditions	4-5	2100 Bless	70-71
135 EC1	6-7	2200 Malibu	72-73
200 Firefly II	8-9	2300 Frio	74-75
235 EC2	10-11	3000 Trullo	76-77
24/7hd	12-13	3280 Ergo-Learn	78-79
300 Beetle	14-15	3400D Khroma	80-81
335 EC3	16-17	3500 Tuxedo	82-83
421 EC4	18-19	3600 Ultima II	84-85
502 Cricket II	20-21	4800 Reward	86-87
512 Cricket Bariatric	22-23	5800 WXO	88-89
535 EC5	24-25	5900 MXO	90-91
610 Emily	26-27	6000 LXO	92-93
635 EC6	28-29	6100 SXO	94-95
700 Firefly	30-31	6200 CXO	96-97
808 Butterfly	32-33	L6200 CXO Leather	98-99
830 Dougie	34-35	6200hd CXO Heavy Duty	100-101
901 Rane	36-37	6200ti CXO Task Intensive	102-103
925 Helen	38-39	6301 GXO	104-105
950 Will	40-41	6401 NXO	106-107
1000 Stool	42-43	6500 OXO	108-109
1100 Tonik	44-45	6800 Bradley	110-111
1220 Danforth II	46-47	6800ti Overtime	112-113
1300 Lakeshore	48-49	7000 Verona	114-115
1310 Joey	50-51	7280 VXO	116-117
1410 Stephanie	52-53	7300 IC2	118-119
1500 Mikey	54-55	7700 Presider	120-121
1509 Johnny	56-57	8600 Manno	122-123
1600 Legacy	58-59	HD9000 Sherman HD	124-125
1700 Soda	60-61	Lifetime Limited Warranty	126-127
1864 Surgeon Console	62-63	Glossary of Abbreviations	128
1900 Amalfi	64-65	Ecological Statement	129
2000 Stratford	66-67		
2020 NLC	68-69		

TABLE OF CONTENTS
Alphabetically by Series Name

24/7hd	12-13	Lakeshore 1300	48-49
Amalfi 1900	64-65	LXO 6000	92-93
Beetle 300	14-15	Malibu 2200	72-73
Bless 2100	70-71	Manno 8600	122-123
Bradley 6800	110-111	Mikey 1500	54-55
Butterfly 808	32-33	MXO 5900	90-91
Cricket II 502	20-21	NLC 2020	68-69
Cricket Bariatric 512	22-23	NXO 6401	106-107
CXO 6200	96-97	Overtime 6800ti	112-113
CXO Heavy Duty 6200hd	100-101	OXO 6500	108-109
CXO Leather L6200	98-99	Presider 7700	120-121
CXO Task Intensive 6200ti	102-103	Rane 901	36-37
Danforth II 1220	46-48	Reward 4800	86-87
Dougie 830	34-35	Sherman HD HD9000	124-125
EC1 135	6-7	Soda 1700	60-61
EC2 235	10-11	Stratford 2000	66-67
EC3 335	16-17	Stephanie 1410	52-53
EC4 421	18-19	Stool 1000	42-43
EC5 535	24-25	Surgeon Console 1864	62-63
EC6 635	28-29	SXO 6100	94-95
Emily 610	26-27	Tonik 1100	44-45
Ergo-Learn 3280	78-79	Trullo 3000	76-77
Firefly 700	30-31	Tuxedo 3500	82-83
Firefly II 200	8-9	Ultima II 3600	84-85
Frio 2300	74-75	Veronna 7000	114-115
GXO 6301	104-105	VXO 7280	116-117
Helen 925	38-39	Will 950	40-41
IC2 7300	118-119	WXO 5800	88-89
Joey 1310	50-51	Ecological Statement	129
Johnny 1509	56-57	Glossary of Abbreviations	128
Khroma 3400D	80-81	Lifetime Limited Warranty	126-127
Legacy 1600	58-59	Terms & Conditions	4-5

TERMS & CONDITIONS

PRICES

Prices are manufacturer's suggested retail list prices and are subject to change without notice. Orders will be invoiced subject to prices prevailing at time of shipment. Please refer to discount schedule for F.O.B. points. Quotes and invoices are subject to correction for any omission or error. All taxes are extra. If purchaser claims an exemption from such taxes, it will be the purchaser's responsibility to provide Nightingale Corp. with the necessary exemption certificate. Notwithstanding anything to the contrary in any purchase order, the terms and conditions of sale contained in this price list will prevail.

TERMS

30 days from date of invoice on standard discount. In event of delinquency, customer shall be liable for all reasonable collection costs incurred. Any products sold shall remain the property of Nightingale Corp. until fully paid.

ORDERS: ALL ORDERS ARE FINAL

A Purchase Order must be submitted to Nightingale Customer Care via fax at 1-800-637-6784 or e-mail at customercare@nightingalechairs.com

Except as noted under "Changes", "Cancellations", and "Returns", below, all orders are deemed final. Customer assumes responsibility for correct information and is required to check acknowledgments carefully for accuracy. If a discrepancy is discovered, it is the Customer's responsibility to inform Nightingale Corp in a timely manner: Nightingale Corp. accepts no responsibility for any errors in interpretation of your Purchase Order unless notified by you within five (5) days. If notification is not received until after the prescribed time, Nightingale Corp. reserves the right to charge the customer for that portion of the order that has been completed up to the date of notification.

Custom finishes are available in metal and wood subject to a sample approved by Nightingale Corp.

Certain options and special requests may require additional lead time. Please contact Customer Care to inquire.

Orders must state clearly:

- Model number
- Quantity
- Fabric name and color number
- Frame finish and/or color number
- Options, if applicable

When ordering a chair with options, please indicate options required by adding the suffix to the model number and add the appropriate option up charge to the list price.

EXAMPLE OF OPTIONS:

6200D-CH-TC

Hard Surface Casters 2" (TC)	\$ 85.00
Polished Aluminum (CH)	\$ 71.00
Model Number 6200D in C1 Mystic Black	\$ 2,900.00
Total List Price	\$ 3,056.00

CHANGES

No Changes without Nightingale Corp.'s consent. Nightingale must be notified in writing immediately if any change is required. Nightingale Corp. reserves the right to charge the customer for that portion of the order that has been completed up to the date of the approved change. Note that if a change in delivery date or site is required after order has shipped, Nightingale Corp. cannot guarantee that changes will be accepted by the carrier-in-transit. Nightingale Corp. will not be responsible for any additional fees or charges incurred as a result of a change in delivery date or site.

CANCELLATIONS: ALL ORDERS ARE DEEMED FINAL

No Cancellations without Nightingale Corp.'s consent. Nightingale Corp. reserves the right to charge the customer for that portion of the order that has been completed up to the date of the approved termination. Orders calling for deviation from our standard construction or finish are final, and no cancellations will be permitted.

RETURNS

No merchandise may be returned without Nightingale Corp.'s prior written consent. **All authorized returns are subject to a 35% restocking charge.** An additional charge may also apply to reinstate merchandise into "new" condition if returned damaged.

All returned shipments must be "prepaid" freight.

CUSTOMER CARE 1-800-363-8954

For general information, replacement parts and special requests, please contact Customer Care.

SHIPPING

Under the Nightingale Delivered Program, Nightingale Corp. reserves the right to determine the carrier and method of shipping. Note that additional charges may apply for special handling and/or special requests.

Every effort is made to ensure sound and secure packaging, however Nightingale Corp.'s liability ends when the carrier issues a clear receipt to Nightingale Corp. that they received the product in good condition.

TERMS & CONDITIONS

All products must be inspected against the packing list and/or bill of lading to confirm product shipments and damages immediately upon delivery. Before signing as received, the box must be opened and the product removed from the box: the receiver must visually inspect the chair, sit in the chair, and test the control mechanism(s). Should the shipment arrive damaged or incomplete, have the carrier make a notation, signed and dated, on the delivery receipt and original freight bill prior to accepting shipment. This will help protect your right to claim damages against the carrier.

A Damage Claim must be filed with Nightingale Customer Care if a product is damaged in shipping: **Freight Damage is not a Warranty claim**, and is handled separately from Warranty claims, under separate terms. Nightingale Corp. will handle the Damage Claim, but the dealer must keep the product in a safe and protected location, unless otherwise instructed by Nightingale Corp. Nightingale Corp. reserves the right to determine how the Damage Claim will be resolved.

All shipping weights shown are approximate.

Note: Shipments made by common carrier are often referred to as LTL (Less than Trailer Load) shipments.

DELIVERED PROGRAM

All models are priced at **DELIVERED** pricing (**1+ CARTONS, Dock to Dock only**).

Please note that if applicable, each chair model in this price list indicates the volume per chair for both fully assembled and KD (Knocked Down).

i.e.: 6200 D - Fully Assembled – Vol. = 19 cu. ft.
6200 D - KD (Knocked Down) – Vol. = 16 cu. ft.

The FOB Destination Freight Program is Dock to Dock shipping only. Additional charges for special handling other than straight “Dock to Dock” will be “prepaid and charge”.

Shipments to Alaska and Hawaii will be shipped FOB West Coast. Nightingale Corp. will not prepay and charge for shipping beyond this point.

CALIFORNIA FIRE CODE #117-2013: STANDARD ON ALL UPHOLSTERED PRODUCTS

California Technical Bulletin 117-2013 is a flaming and smoldering fire performance test for filling and/or cushioning and upholstery cover fabrics.

CUSTOMER'S OWN MATERIAL

Note: All pricing for C.O.M. product is based on grade 1 pricing.

Fabric must be shipped to the factory prepaid. All yardage indicated in this book is approximate, based on 54” non directional, no patterned goods. Additional yardage may be required for directional, patterned and lesser width materials.

- Materials will be applied in what Nightingale Corp. feels is appropriate unless instructed otherwise.
- Nightingale Corp. reserves the right to reject any material as unsuitable.
- In accepting C.O.M. fabric, Nightingale Corp. assumes no responsibility for fabric wear, defects or appropriateness and is applied at customer's own risk.
- When supplying C.O.M. material, the shipment must be clearly tagged with customer's order number, description of product, quantity of fabric and any special instructions.
- Nightingale Corp. will not accept C.O.M. material that is sent freight collect. Any brokerage fees paid by Nightingale Corp. on C.O.M. material will be charged back to the customer accordingly.

LEATHER

Genuine leather is available on selected models as indicated. For special requests please contact Customer Care.

SPECIFICATIONS

Nightingale Corp. reserves the right to institute changes with regard to materials, equipment, specifications or design, as well as to discontinue models and/or fabrics at any time without prior notice.

DESIGN/TRADEMARKS

Many of the products produced by Nightingale Corp. are protected by Design Registration, Trademarks and Patents.

DESIGN/TRADEMARKS

Most Nightingale Corp. seating products meet or exceed industry standards such as ANSI / BIFMA (American National Standards Institute/Business Institutional Furniture Manufacturers Association).

The EC1 is a classic conference chair with a simple style to enhance any boardroom aesthetic.

STANDARD FEATURES

- Integrated lumbar support.
- Enhanced with Enersorb™ memory foam seat for enhanced comfort and durability.
- Fixed height arm rest.
- 5-prong black nylon base.
- Sleek mechanism with synchro-tilt swivel, tension control and seat-depth adjustment.
- Standard 2" carpet casters.
- Adjustable seat depth adjustment.
- ANSI/BIFMA approved and TB117-2013 compliant.

GENERAL INFORMATION

- Upholstery: 2 yd/chair
- Finish - Mechanism, arms, base, casters and trim standard in black



EC1 Series 135-TC

RATED FOR

300lbs



EC1 Series 135-TC

Model	Description	1	2	3	4	5	6	7	8	Leather Plus	Madras Leather	Princess Leather
135	Mid-Back Conference	1121	1234	1320	1347	1460	1572	1687	1800	1347	1341	1588



135

OPTIONS

Description	Suffix	Models	Upcharge
2" Hard Casters	TC	135	85
3" Carpet Casters	LG	135	85
3" Hard Surface Casters	TC3	135	149
Armless	07	135	-30

DIMENSIONS

Model	Overall Width	Overall Depth	Overall Height	Seat Height	Weight	Volume	KD Volume	Base Dia.
135	26.75"	23"	36"-41.25"	17"- 22.5"	40 lbs	17 cu ft	11 cu ft	27"

The Firefly II is a part of our stackable collection. They're functional, flexible, strong, and versatile. The perfect solution for any environment.

STANDARD FEATURES

- Mesh backing on the 200M model allows for comfortable air circulation and dynamic ergonomic support.
- Waterfall seat design on all models to reduce muscle fatigue.
- Stacks 10 chairs on a dolly and 6 high free standing.
- Contoured nylon arms as shown.
- Light and easy to move.
- Frame 1" O.D. 16 gage round steel tubing, with contoured rear angled legs for stability and to act as a wall saver.
- All models (except mesh back) feature a black polypropylene back shell for durability and protection.
- Frame finish: high impact epoxy powder coat, electro-statically applied for corrosion resistance, standard in semi-gloss black.
- Model 200 and 201 feature an all plastic seat and back for ease of cleaning where a simple seating solution is desired.

GENERAL INFORMATION

- Upholstery:
 - UFST - 0.5 yd/chair
 - UF - 1 yd/chair



Firefly II 200



Model	Description	Plastic Shell Black Only	1	2	3	4	5	6	7	8	Leather
200	Stacker	509									
200UST	Stacker Upholstered Seat		571	593	615	636	656	678	699	720	685
200UPH	Stacker Upholstered Seat & Back		656	699	740	781	819	862	904	946	881
200MUFST	Stacker Mesh Back & Upholstered Seat		656	677	699	720	740	762	783	805	762
200MPS	Stacker Mesh Back & Plastic Seat	598									



200-CA



200MPS-CH



200MUFST-CH



200



200UPH-CH-CA

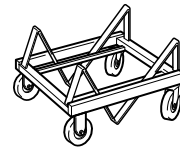

20D Dolly / 200TD



200MUFST-01

OPTIONS

Description	Suffix	Models	Upcharge
Chrome Arms	CH	All Models	35
2" Carpet Casters	CA	All Models	71
Dolly - 200TD	20D	All Models	840
2" Hard Surface Casters	CA, TC	All Models	144
Armless Stacker	01	All Models	-54

DIMENSIONS

Model	Overall Width	Overall Depth	Overall Height	Seat Height	Weight 3 or 1 per carton	Volume 1 per carton
200	24.75"	22"	33.25"	17"	50 lbs / 22 lbs	14.5 cu ft / 11 cu ft
200UST	24.75"	22"	33.25"	17.75"	51 lbs / 23 lbs	14.5 cu ft / 11 cu ft
200UPH	24.75"	22"	33.25"	17.75"	51 lbs / 23 lbs	14.5 cu ft / 11 cu ft
200MUFST	24.75"	22"	33.25"	17.75"	51 lbs / 23 lbs	14.5 cu ft / 11 cu ft
200MPS	24.75"	22"	33.25"	17.75"	51 lbs / 23 lbs	14.5 cu ft / 11 cu ft

Sleek and executive, the EC2 is designed for comfort and support so that you can focus on the tasks at hand.

STANDARD FEATURES

- Polished aluminum arms with molded polyurethane arm pads.
- Enhanced with Enersorb™ memory foam seat and molded foam back for enhanced comfort and durability.
- Waterfall seat design to reduce muscle fatigue.
- Built-in integrated head-rest support.
- 5-prong, two tone, polished aluminum base.
- Knee-tilt mechanism & multi-position tilt lock with slow release.
- Compound curved back for passive lumbar support.
- 2" mag wheel carpet casters.
- ANSI/BIFMA approved and TB117-2013 compliant.

GENERAL INFORMATION

- Upholstery: 3 yd/chair



EC2 Series 235D

RATED FOR

300lbs



EC2 Series 235D

Model	Description	1	2	3	4	5	6	7	8	Leather Plus	Madras Leather	Princess Leather
235D	High-Back Executive	1405	1503	1602	1700	1798	1898	1997	2095	1588	1793	1990



235D

OPTIONS

Description	Suffix	Models	Upcharge
2" Hard Casters	TC	235D	85
3" Carpet Casters	LG	235D	85
3" Hard Surface Casters	TC3	235D	149
Custom Embroidery*	EM	235D	226

**Standard charge for customer embroidery assumes an approved DST file will be provided at time of order placement. If a DST file needs to be created an additional \$300 list fee will apply. Note, there is a minimum order quantity of 8 units.*

DIMENSIONS

Model	Overall Width	Overall Depth	Overall Height	Seat Height	Weight	Volume	KD Volume	Base Dia.
235D	24.25"	30"	43"-46.25"	18.5"-22"	50 lbs	17 cu ft	16 cu ft	26"

This heavy-duty chair accommodates individuals up to 450lbs. Ideal for EMS workers, police officers, and any multi-shift 24hr work environment. Fits most body types with its exceptional ergonomic support all day long.

STANDARD FEATURES

- Swivel-tilt mechanism, infinite position tilt lock complete with back seat depth adjustment, pneumatic height adjustment, tension control (Type 28).
- High density, high resiliency, dual density foam with ENERSORB™ seat topper.
- Ratchet headrest (247hd-HR).
- Waterfall seat design to reduce muscle fatigue.
- Seat reinforced by ¼" thick steel plates that have arms and mechanism attached to it for exceptional strength.
- Built-in lumbar back support.
- Lever operated width and height adjustable arms with polyurethane waterfall arm pad.
- 5 prong heavy duty aluminum base with 3" dual wheel carpet casters.
- Arms, base, and trim standard in black finish.
- ANSI/BIFMA approved and TB117-2013 compliant.

GENERAL INFORMATION

- Upholstery: 2.5 yd/chair



The 24/7HD has phenomenal extra support. Reinforcements along the chair base and back make this even more durable than our standard chairs, able to support up to 450lbs.

RATED FOR

450lbs



24/7hd-TC Mid-Back Intensive Task

Model	Description	1	2	3	4	5	6	7	8	Leather Plus	Madras Leather	Princess Leather
24/7hd-HR	High Back Heavy Duty Task with Headrest	2753	2859	2957	3069	3175	3281	3388	3493	3084	3025	3600
24/7hd	Mid Back Heavy Duty Task	2590	2683	2767	2859	2943	3027	3111	3197	2865	3049	3253



24/7hd-HR



24/7hd

OPTIONS

Description	Suffix	Models	Upcharge
Armless	07	All Models	-145
Fold Away Arms	FA	All Models	276
3" Hard Surface Casters	TC3	All Models	85
Polished Aluminum Base	CH	All Models	71
Adjustable Lumbar Support	LU	All Models	141
Custom Embroidery*	EM	24/7hd-HR	226

**Standard charge for customer embroidery assumes an approved DST file will be provided at time of order placement. If a DST file needs to be created an additional \$300 list fee will apply. Note, there is a minimum order quantity of 8 units.*

DIMENSIONS

Model	Overall Width	Overall Depth	Overall Height	Seat Height	Weight	Volume	KD Volume
24/7hd-HR	27.5" - 31.5"	28.5" - 30.5"	48.5" - 54"	17" - 21"	91 lbs	20 cu ft	16 cu ft
24/7hd	27.5" - 31.5"	28.5" - 30.5"	37.25" - 42"	17" - 21"	81 lbs	16 cu ft	11 cu ft

This convenient, high-density stackable chair is a comfortable, supportive seating solution. Ideal for educational, institutional, mass seating, or occasional use.

STANDARD FEATURES

- Chrome plated 7/16" solid bar frame for strength and durability.
- Frame cross bar set back to provide greater leg clearance.
- Standard frame notched to accept optional floor glides.
- Stacks 45 high (18 when upholstered) with #30D dolly and will pass through a standard doorway height of 79" (UPH1830D).
- Upholstered models stack 18 high on a dolly and comes complete with separators to prevent damage to fabric and foam.
- Textured polypropylene seat and back shells contoured for ergonomic comfort.
- Plastic shell available in standard black.
- Frame finish is duplex nickel chrome for appearance in durability.
- ANSI/BIFMA approved and TB117-2013 compliant.

GENERAL INFORMATION

- Upholstery: ¾ yd/chair
- Finish for 300AT tablet arm is standard in black laminate with solid hardwood core. Please specify Left Hand (L) or Right Hand (R) when sitting.
- 300AT does not stack
- 30D stacks up to 45 chairs
- 1630D stacks up to 18 chairs
- Patented Design.



Beetle 300ATR



Beetle 308, stacked on the 30D Dolly

Model	Description	Base	1	2	3	4	5	6	7	8	Leather
308	High Density Stacker Armless	416									
308UF	High Density Stacker Armless Upholstered Seat and Back		615	636	672	691	714	734	756	781	854
300AT	Side Chair with Tablet Arm	720									
300AT-UF	Side Chair with Tablet Arm Upholstered Seat and Back		917	939	974	995	1017	1037	1058	1083	1157



308



300ATL

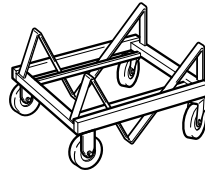

30D Dolly / U300TD

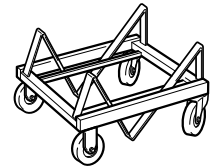

30D Dolly / 16UPH30D

OPTIONS

Description	Suffix	Models	Upcharge
Plastic Shell Color	BL / Black	All Models	N/C
Hard Plastic Glide (x4)	GHN	All Models	22
Soft Plastic Glide (x4)	GSN	All Models	22
Welding Ganging Wire Hook	GW	308	49
30D Dolly / U300TD	30D	308	840
30D Dolly / 16UPH30D	UPH30D	308UF	615

DIMENSIONS

Model	Overall Width	Overall Depth	Overall Height	Seat Height	Weight	Volume	Per Carton
308	19"	22.5"	32.25"	18"	80 lbs 16 lbs	16 cu ft 11 cu ft	5 Chairs (LTL) 1 Chair (UPS)
300AT	20"	22.5"	32.25"	18"	26 lbs	16 cu ft	1 Chair (LTL)
30D/1830D	22.5"	25.5"	14.5"	N/A	30 lbs	5 cu ft	1

The EC3 evokes a clean aesthetic and polished feel. With its full-back and spring support system built into the molded foam, the EC3 combines ergonomic support with modern style.

STANDARD FEATURES

- Synchro-tilt mechanism includes multi-position tilt lock with slow release, pneumatic height adjustment and side tension control.
- High density, high resiliency, molded back and headrest foam with an Enersorb™ top layer.
- Full back, dynamic, self adjusting spring support system.
- Fixed height, polished aluminum arms with polyurethane arm pads.
- Waterfall seat design to reduce muscle fatigue.
- Built in headrest support.
- 5 Prong polished aluminum base.
- 3" Dual wheel carpet casters.
- ANSI/BIFMA approved and TB117-2013 compliant.

GENERAL INFORMATION

- Upholstery:
 - Model 335D - 2.5 yd/chair
 - Model 335 - 2 yd/chair
 - UC - 0.25 yd/chair
- Patent Pending.

RATED FOR



EC3 Series 335D-TC3



EC3 Series 335D-A

Model	Description	1	2	3	4	5	6	7	8	Leather Plus	Madras Leather	Princess Leather
335D	High Back Executive	1912	2062	2195	2343	2492	2640	2730	2949	2047	2513	2724
335	Mid Back Executive	1743	1891	2040	2188	2336	2484	2632	2781	1877	2343	2555



335D



335



335D-A

OPTIONS

Description	Suffix	Models	Upcharge
3" Hard Surface Casters	TC3	All	149
3D Height, Pivot, Front to Back Adjustable Arms	A	335, 335D	0
Upholstered Arm Caps <i>(Leathers and vinyls only, not available on adjustable arms.)</i>	UC	335, 335D	63
Custom Embroidery*	EM	335D	226

*Standard charge for customer embroidery assumes an approved DST file will be provided at time of order placement. If a DST file needs to be created an additional \$300 list fee will apply. Note, there is a minimum order quantity of 8 units.

DIMENSIONS

Model	Overall Width	Overall Depth	Overall Height	Seat Height	Weight	Volume	KD Volume
335D	26"	26"	44"- 47.5"	16.5"- 20"	59 lbs	19 cu ft	16 cu ft
335	27.25"	26"	37.5"- 40.75"	16.5"- 20"	53 lbs	19 cu ft	16 cu ft
335D-A	27.25"	26"	44"- 47.5"	16.5"- 20"	63 lbs	19 cu ft	16 cu ft

The perfect companion to your executive task chair, the EC4 is an elegant, comfortable guest chair. Perfect for offices, meeting rooms, waiting rooms and multi-use seating.

STANDARD FEATURES

- Polished aluminum ribbon-tapered arms for sophisticated and alluring look.
- Equipped with polyurethane arm caps.
- Fully upholstered back and seat.
- Designed with high-resiliency molded foam.
- ANSI/BIFMA approved and TB117-2013 compliant.

GENERAL INFORMATION

- Upholstery:
 - Model 421 - 2 yd./chair
- Patent Pending.



EC4 Series 421



EC4 Series 421

Model	Description	1	2	3	4	5	6	7	8	Leather Plus	Madras Leather	Princess Leather
421	Executive Guest Chair	1121	1192	1263	1333	1404	1474	1545	1616	1333	1567	1800



421

DIMENSIONS

Model	Overall Width	Overall Depth	Overall Height	Seat Height	Weight	Volume	KD Volume
421	24"	25"	35"	17.5"	36 lbs	17 cu ft	N/A

With its bright colors and stackability, the Cricket II adds a pop of fun to any common space! The perfect guest chair for multi-use functions.

STANDARD FEATURES

- Frame 7/8" outside diameter, 16 gage heavy duty round tubular steel.
- Frame finish: high impact epoxy powder coat, electro-statically applied for corrosion resistance, standard in semi-gloss black.
- Compound square back provides superior comfort and support.
- Stacks 10 high on #60D dolly and stacks 6 high, free standing.
- High-density foam for durability.
- Rear-angled back legs for stability.
- Chrome plated metal cushion glides (502, 503).
- Upholstered seat and back.
- Flared design black nylon arm (502).
- ANSI/BIFMA approved and TB117-2013 compliant.

GENERAL INFORMATION

- Upholstery (All Models) - 1.5 yd/chair



Cricket II 502



Cricket II 503 stacked 6 high.

Model	Description	1	2	3	4	5	6	7	8	Leather
502	Side Chair with Flared Arms	495	523	551	593	621	650	678	705	685
503	Side Chair Armless	473	500	529	571	600	629	656	685	664



Cricket II 502



503



502

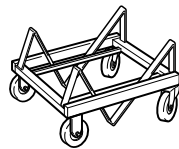

60D Dolly / U600TD

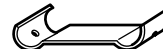

Chair to Chair Ganging Connector / 15511

OPTIONS

Description	Suffix	Models	Upcharge
Chrome Frame	CH	All Models	71
60D Dolly / U600TD	60D	502, 503	876
15511 Chair to Chair Ganging Connector	15511	502, 503	35
2" Carpet Casters	CA	502	187

DIMENSIONS

Model	Overall Width	Overall Depth	Overall Height	Seat Height	Weight	Volume	Per Carton
502	24"	22"	33"	18.5"	20 lbs	14.5 cu ft	4 chairs LTL / 1 chair UPS Cannot be ganged
503	20.25"	22"	33"	18.5"	20 lbs	14.5 cu ft	4 chairs LTL / 1 chair UPS

The Cricket Bariatric is a heavy duty seat, capable of holding up to 500lbs. It is well suited for healthcare applications, including reception and guest seating requirements.

STANDARD FEATURES

- Models 512 and 513 are sized to accommodate users up to 300 lbs.
- Models 522 and 523 are sized to accommodate users up to 400 lbs.
- Models 532 and 533 are sized to accommodate users up to 500 lbs.
- Heavy duty 7/8" diameter, 13 gage steel frame with extra seat stretcher for structural integrity.
- Welded corner braces for added strength.
- Rear angled back legs for stability.
- Separate seat and back for easy cleaning.
- ANSI/BIFMA approved and TB117-2013 compliant.

GENERAL INFORMATION

- Upholstery:
 - Models 512 & 513 - 1.5 yd/chair
 - Models 522 & 523 - 1.75 yd/chair
 - Models 532 & 533 - 2 yd/chair

Note: Sled base does not stack.



Cricket Bariatric 533

RATED FOR

300lbs

400lbs

500lbs



Cricket Bariatric 512

Model	Description	1	2	3	4	5	6	7	8	Madras Leather	Princess Leather
512	Bariatric Sled Base 300lbs Capacity	1022	1072	1121	1172	1220	1270	1320	1369	1347	1488
513	Bariatric Armchair 300lbs Capacity	982	1031	1080	1130	1178	1228	1280	1328	1307	1448
522	Bariatric Sled Base 400lbs Capacity	1107	1159	1207	1257	1306	1355	1405	1456	1433	1575
523	Bariatric Armchair 400lbs Capacity	1058	1107	1159	1207	1257	1307	1356	1405	1385	1525
532	Bariatric Sled Base 500lbs Capacity	1298	1376	1454	1533	1610	1688	1765	1842	1928	2076
533	Bariatric Armchair 500lbs Capacity	1234	1313	1390	1469	1545	1624	1700	1779	1864	2011



DIMENSIONS

Model	Overall Width	Overall Depth	Overall Height	Seat Height	Weight	Volume	Per Carton
512	23.75"	21.75"	31.75"	18.5"	20 lbs	11 cu ft 14.5 cu ft	1 Chairs (LTL) 1 Chair (UPS)
513	23.75"	21.75"	31.75"	18.5"	20 lbs	11 cu ft 14.5 cu ft	4 Chairs (LTL) 1 Chair (UPS)
522	27.75"	21.75"	31.75"	18.5"	25 lbs	13 cu ft 16 cu ft	1 Chairs (LTL) 1 Chair (UPS)
523	27.75"	21.75"	31.75"	18.5"	25 lbs	13 cu ft 16 cu ft	2 Chairs (LTL) 1 Chair (UPS)
532	31.75"	21.75"	31.75"	18.5"	26 lbs	15 cu ft 15 cu ft	1 Chairs (LTL) 1 Chair (UPS)
533	31.75"	21.75"	31.75"	18.5"	26 lbs	15 cu ft 15 cu ft	1 Chairs (LTL) 1 Chair (UPS)

The EC5 provides a classic look with a modern finish. With comfortable ergonomic support and sleek chrome arms, the EC5 is a premium executive chair.

STANDARD FEATURES

- Polished aluminum arms with molded polyurethane arm pads.
- Integrated head-rest support.
- High-density, high-resiliency, molded back foam with a full-back, dynamic, self-adjusting spring support system embedded into the molded foam.
- Enersorb™ memory foam seat for enhanced seating comfort and durability.
- Synchro-tilt swivel & multi-position tilt-lock with slow release and side tension control.
- Waterfall seat design to reduce muscle fatigue.
- 3" Carpet casters.
- 5-prong polished aluminum base.
- ANSI/BIFMA approved and TB117-2013 compliant.

GENERAL INFORMATION

- Upholstery:
 - 2.5 yd/chair



EC5 Series 535D-UC-TC3

RATED FOR

300lbs



EC5 Series 535D-TC3

Model	Description	1	2	3	4	5	6	7	8	Leather Plus	Madras Leather	Princess Leather
535D	High-Back Executive	2019	2166	2301	2448	2597	2745	2894	3055	2252	2611	2816



535D

OPTIONS

Description	Suffix	Models	Upcharge
3" Hard Surface Casters	TC3	535D	147
Upholstered Arm Caps	UC	535D	63
Custom Embroidery*	EM	535D	226

**Standard charge for customer embroidery assumes an approved DST file will be provided at time of order placement. If a DST file needs to be created an additional \$300 list fee will apply. Note, there is a minimum order quantity of 8 units.*

DIMENSIONS

Model	Overall Width	Overall Depth	Overall Height	Seat Height	Weight	Volume	KD Volume	Base Dia.
535D	24.24"	24"	44.5"-48"	16.75"-20.75"	60 lbs	19 cu ft	N/A	26"

The Emily is a dual-model collection consisting of a lounge chair and a cylindrical table-stool. Playful and multi-functional, the Emily is a winning combination of comfort and creativity.

STANDARD FEATURES

- High-density, resiliency foam for comfort and support.
- Molded nylon black base.
- Freestanding side table (610 model only). Black only.
- Pneumatic adjustment mechanism with auto-return feature and single-position lock.
- ANSI/BIFMA approved and TB117-2013 compliant.

GENERAL INFORMATION

- Upholstery:
 - Model 611 - 2 yd/chair
 - Model 610 - 1.25 yd/chair



Emily 611



Emily 610

Model	Description	1	2	3	4	5	6	7	8	Leather Plus	Madras Leather	Princess Leather
610	Stool / Table	720	748	777	806	833	868	895	924	806	881	951
611	Lounge Seat	2350	2492	2717	2943	3169	3394	3620	3903	2943	3591	4220



Emily 611 (Lounge Seat) & 610 (Stool/Table)

OPTIONS

Description	Suffix	Models	Upcharge
Dual Tone Upholstery*	DT	611	0

*When selecting Dual Tone Upholstery chair will be graded in the higher of two textiles selected.

DIMENSIONS

Model	Overall Width	Overall Depth	Overall Height	Seat Height	Weight	Volume 1 per carton
610	15.5"	15.5"	18"	16.5"	28 lbs	6 cu ft
611	28.5"	31.5"	36.5"	17"	60 lbs	N/A

The EC6 is inspired by the look of modern offices. It combines a polished, design-forward look with our best ergonomic support. The ultimate in executive comfort and style.

STANDARD FEATURES

- Fully upholstered closed arms.
- Integrated head rest support (Model 635D).
- High-density, high-resiliency molded seat and back foam for comfort and support.
- Mechanical, height-adjustable lumbar support.
- Synchro-tilt mechanism with pneumatic height adjustment, multi-position tilt lock with slow release and side tension control.
- Waterfall seat design to reduce muscle fatigue.
- 5-prong polished aluminum legs and lumbar adjuster.
- 3" carpet casters.
- ANSI/BIFMA approved and TB117-2013 compliant.

GENERAL INFORMATION

- Upholstery: 3 yd/chair

RATED FOR

300lbs



EC6 Series 635D-DT-TC3



EC6 Series 635D-TC3

Model	Description	1	2	3	4	5	6	7	8	Leather Plus	Madras Leather	Princess Leather
635D	High Back Executive	2160	2307	2443	2590	2739	2886	3036	3197	2392	2753	2957
635	Mid Back Executive	2110	2258	2392	2541	2688	2837	2984	3148	2343	2703	2908



635D



635

OPTIONS

Description	Suffix	Models	Upcharge
3" Hard Surface Casters	TC3	All Models	85
Dual Tone Upholstery*	DT	All Models	0
Custom Embroidery*	EM	635D	226

**When selecting Dual Tone Upholstery, chair will be graded in the higher of two textiles selected.*

**Standard charge for customer embroidery assumes an approved DST file will be provided at time of order placement. If a DST file needs to be created an additional \$300 list fee will apply. Note, there is a minimum order quantity of 8 units.*

DIMENSIONS

Model	Overall Width	Overall Depth	Overall Height	Seat Height	Weight	Volume
635D	27"	28"	45-48.5"	16.5-20.5"	60lbs	19 cu ft
635	27"	28"	39"- 42.5"	16.5"- 20.5"	58lbs	19 cu ft

The Firefly is functional, flexible, strong, and versatile. The perfect solution for any environment.

STANDARD FEATURES

- Mesh backing on the 700M model allows for comfortable air circulation and dynamic ergonomic support.
- Waterfall seat design on all models to reduce muscle fatigue.
- Open contoured nylon arms as shown.
- Light and easy to move.
- Frame 1" O.D. 16 gage round steel tubing.
- All models (except mesh back) feature a black polypropylene back shell for durability and protection.
- Frame finish: high impact epoxy powder coat, electrostatically applied for corrosion resistance, standard in semi-gloss black.
- Model 700 and 701 feature an all plastic seat and back for ease of cleaning where a simple seating solution is desired.

GENERAL INFORMATION

- Upholstery:
 - UFST - 0.5 yd/chair
 - UF - 1 yd/chair



Firefly 700



Firefly 700MUFST

Model	Description	Plastic Shell Black Only	1	2	3	4	5	6	7	8	Leather
700	Poly Seat & Back	513									
701	Poly Seat & Back Armless	449									
700UST	Upholstered Seat Poly Back		571	591	617	637	654	680	700	719	687
701UST	Armless Upholstered Seat Poly Back		513	534	553	571	591	617	636	654	622
700UPH	Upholstered Seat & Back		654	700	745	670	822	860	905	943	887
701UPH	Armless Upholstered Seat & Back		584	630	674	705	751	791	834	874	815
700MUFST	Mesh Back & Upholstered Seat		654	700	745	777	822	860	905	943	887
701MUFST	Armless Mesh Back & Upholstered Seat		584	630	674	705	751	791	834	874	815
700MPS	Mesh Back & Plastic Seat	604									
701MPS	Armless Mesh Back & Plastic Seat	539									



700

700UST

700UPH

700MUFST

700MPS

OPTIONS

Description	Suffix	Models	Upcharge
Chrome Frame	CH	All Models	36
2" Carpet Casters	CA	All Models	71

DIMENSIONS

Model	Overall Width	Overall Depth	Overall Height	Seat Height	Weight 3 or 1 per carton	Volume 1 per carton
700	23.25"	22"	31.75"	16.5"	50 lbs / 22 lbs	14.5 cu ft / 11 cu ft
700UST	23.25"	22"	31.75"	17.75"	51 lbs / 23 lbs	14.5 cu ft / 11 cu ft

Lightweight and mobile, the Butterfly encourages freedom and versatility in your office space. It is perfect for work stations and multi-use rooms.

STANDARD FEATURES

- Frame on all models except task chairs 7/8" O.D 16 gage round steel tubing.
- Ideal for informal, flexible spaces where reconfiguration is encouraged, smaller scale is important, and budget is a concern.
- Task chairs feature swivel mechanism and a 5-pronged nylon base with carpet casters.
- Simple to stack. Stacks 6 high (808 & 811).
- Contemporary design with a durable polypropylene seat and back shell (black only).
- Standard with black frame finish.
- Waterfall seat to reduce muscle fatigue.
- ANSI/BIFMA approved and TB117-2013 compliant.

GENERAL INFORMATION

- Upholstery:
 - Seat only - ¾ yd



Butterfly 811UFST

OPTIONS

Description	Suffix	Models	Upcharge
Twin Wheel Carpet Casters	CA	808, 811	84
2" Hard Surface Casters	TC	800, 807	94
2" Hard Surface Casters	CA, TC	808, 811	144
Chrome Legs	CH	808, 809, 810, 811	66
Chrome Base	CH	800, 807	125
Sit / Stand Drafting Stool	DS	800, 807	157

DIMENSIONS

Model	Overall Width	Overall Depth	Overall Height	Seat Height	Weight 3 or 1 per carton	Volume 1 per carton
800	24"	23.5"	30.5" - 35.5"	16" - 21"	1 per carton	14.5 cu ft / 11 cu ft
808 / 811	22.5"	21.5"	32.5"	18"	3 per carton	14.5 cu ft / 11 cu ft
809 / 810	20"	25"	44.5"	30"	1 per carton	14.5 cu ft / 11 cu ft

Model	Description	Plastic Shell Black Only	1	2	3	4	5	6	7	8	Leather
808	Stacker Armless	395									
808UFST	Stacker Armless Upholstered Seat Only		467	480	495	509	523	537	551	566	551
811	Stacker with Arms	480									
811UFST	Stacker with Arms Upholstered Seat Only		557	571	585	600	615	629	642	656	650
809	Barstool Armless	615									
809UFST	Barstool Armless Upholstered Seat Only		699	713	727	741	756	769	783	797	777
810	Barstool with Arms	699									
810UFST	Barstool with Arms Upholstered Seat Only		777	792	811	826	840	854	868	881	872
807	Task Armless	621									
807UFST	Task Armless Upholstered Seat Only		692	705	720	734	748	762	777	792	777
800	Task with Arms	720									
800UFST	Task with Arms Upholstered Seat Only		792	806	819	833	847	862	876	890	910



808



811



809



810



807



800

Design-forward and comfortable, the Dougie is a lounge chair with artistic flare. Eye-catching with its clean lines and tailored finish, it's a stunning addition to any modern space.

STANDARD FEATURES

- Molded, high-density foam. Steel frame structure.
- Product design allows for two-tone upholstery.
- Satin aluminum legs with adjustable glides.
- Fully upholstered seat and back.
- Waterfall seat design to reduce muscle fatigue.
- Generously proportioned seat and back.
- ANSI/BIFMA approved and TB117-2013 compliant.

GENERAL INFORMATION

- Upholstery: 3 yd/chair
- Optional ganging bracket available - GANG



Dougie 830



Dougie 830

Model	Description	1	2	3	4	5	6	7	8	Leather Plus	Madras Leather	Princess Leather
830	Lounge/Guest Chair	2217	2343	2470	2597	2710	2823	2933	3049	2611	2979	3310



830



Shown ganged

OPTIONS

Description	Suffix	Models	Upcharge
Ganging Connector (Used for grouping chairs together)	GANG	All	36

DIMENSIONS

Model	Overall Width	Overall Depth	Overall Height	Seat Height	Weight	Volume
830	24"	28"	32"	16.5"	35 lbs	17 cu ft

The Rane is a multi-function lounge seat with a geometric design. The adjustable back rest swings and locks in a variety of positions, resulting in a versatile chair reminiscent of a Rubik's Cube.

STANDARD FEATURES

- Designed by Rane Vaskivuori/Valvomo.
- Features an innovative adjustable swinging and locking backrest offering the flexibility to create unique and personalized seating configurations.
- ANSI/BIFMA approved and TB117-2013 compliant.

GENERAL INFORMATION

- Upholstery:
 - Model 901 - 4 yd/chair
 - Model 902 - 3.5 yd/chair
 - Model 900B - 2 yd/chair



Rane 901-DT



Rane 901

Model	Description	1	2	3	4	5	6	7	8	Leather Plus	Madras Leather	Princess Leather
901	Lounge with Backrest	3939	4157	4383	4601	4827	5053	5279	5505	4622	5081	5568
900B	Lounge Half Bench	1673	1785	1891	2004	2117	2231	2343	2457	2011	2244	2484
902	Lounge Full Bench	2688	2851	3013	3190	3337	3501	3609	3825	3190	3315	3853



901



900B



902

OPTIONS

Description	Suffix	Models	Upcharge
Dual Tone Upholstery*	DT	901	0

*When selecting Dual Tone Upholstery chair will be graded in the higher of two textiles selected.

DIMENSIONS

Model No.	Overall Width	Overall Depth	Overall Height	Seat Height	Weight	Volume
901	36"	36"	29.5"	16.5"	95 lbs	19 cu ft
900B	36"	18"	16.5"	16.5"	32 lbs	9 cu ft
902	36"	36"	16.5"	16.5"	80 lbs	19 cu ft

Ideal for teamwork and impromptu meetings, the Helen is a retro-chic chair that fuels start-up culture. It is the perfect solution for fostering creative interactions in comfortable, collaborative workspaces.

STANDARD FEATURES

- Well-proportioned, armless lounge chair.
- Tapered aluminum legs with high-impact, silver epoxy, powder coat paint, electro-statically applied for corrosion resistance.
- Fully upholstered seat, back and bottom.
- High-density, high-resiliency seat and back foam for comfort and support.
- ANSI/BIFMA approved and TB117-2013 compliant.

GENERAL INFORMATION

- Upholstery (All Models): 3 yd/chair



Helen 925



Helen 925

Model	Description	1	2	3	4	5	6	7	8	Leather Plus	Madras Leather	Princess Leather
925	Lounge Chair Armless	1094	1186	1278	1369	1460	1553	1644	1737	1369	1714	1955



925

DIMENSIONS

Model	Overall Width	Overall Depth	Overall Height	Seat Height	Weight	Volume
925	27"	26"	30"	17"	30 lbs	18 cu ft

The Will is an ideal lounge seat. Its cushioned support and high arms make it the maximum in elegant comfort for small or large spaces.

STANDARD FEATURES

- Fully upholstered, modular wood frame for strength and durability.
- Components are easily replaceable.
- Can be assembled in minutes without tools.
- Standard satin aluminum legs.
- ANSI/BIFMA approved and TB117-2013 compliant.

GENERAL INFORMATION

- Upholstery: 6 yd/chair
- Please specify outlet location for EL option
 - *EL-RH for right handed sitter*
 - *EL-LH for left handed sitter*



Will 950

Modular System:

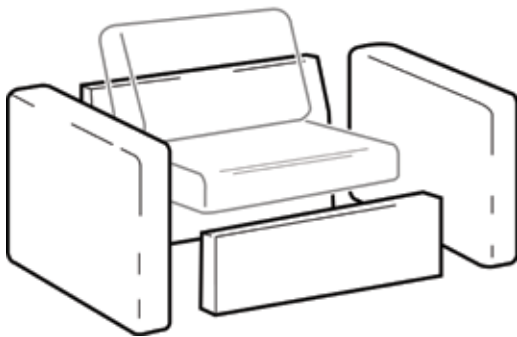

Will 950

Model	Description	1	2	3	4	5	6	7	8	Leather Plus	Madras Leather	Princess Leather
950	Modular Lounge Chair	1962	2266	2547	2851	3148	3444	3741	4037	2879	3944	4918



950



950-EL-RH

OPTIONS

Description	Suffix	Models	Upcharge
Braking Casters	BRK	All Models	141
Electrical / USB Port (Specify LH or RH as per general info.)	EL	All Models	353

DIMENSIONS

Model	Overall Width	Overall Depth	Overall Height	Seat Height	Weight	Volume	KD Volume
950	29"	30"	28.5"	18"	74 lbs	20 cu ft	12 cu ft

Stool

1000

This economical, comfortable stool is an ideal chair for use in medical, dental, laboratory, or small-space environments where mobility and quality are essential.

STANDARD FEATURES

- Swivel mechanism featuring a 5.5" pneumatic seat height adjustment.
- High density, high resiliency foam for added durability and comfort (1000, 1000WB).
- Finish: mechanism, base, casters, and trim standard in black.
- 5-prong, heavy-duty nylon base with 2" dual wheel carpet casters.
- Molded polyurethane seat and back for durability and hygienic requirements (1010).
- ANSI/BIFMA approved and TB117-2013 compliant.

GENERAL INFORMATION

- Upholstery:
 - Model 1000 - 0.5 yd/chair
 - Model 1000WB - 1.5 yd/chair
 - Model 1009 - 1 yd/chair



Stool 1000-WB-DS



Stool 1009

Model	Description	1	2	3	4	5	6	7	8	Madras Leather	Princess Leather
1000	Stool	543	571	600	629	656	685	713	741	705	806
1000WB	Stool with Back and Casters	720	777	833	890	946	1002	1058	1116	1009	1159
1009	Stool Trumpet Base	509	537	566	593	629	656	685	713	670	741
1010	Stool with Polyurethane Seat Back	982									



OPTIONS

Description	Suffix	Models	Upcharge
Non-Marking Hard Surface Sit to Lock Casters / When seated	RLC	1000, 1000WB, 1010	78
Non-Marking Hard Surface Stand to Lock Casters / When standing	SLC	1000, 1000WB, 1010	78
Glides	G	1000, 1000WB, 1010	63
Height Adjustable Foot Ring	DS	1000, 1000WB, 1010	134
Hard Surface Casters	TC	1000, 1000WB, 1010	85
Chrome	CH	1000, 1000WB, 1010	71
Gas Lift	GL	1009	71

DIMENSIONS

Model	Overall Width	Overall Depth	Overall Height	Seat Height	Weight	Volume
1000	24"	24"	16.5" - 22"	16.5" - 22"	18 lbs	12 cu ft
1000 WB	27.5"	27.5" - 30"	32" - 37"	16.5" - 22"	22 lbs	12 cu ft
1010	25"	25" - 27"	30.75" - 35"	15.5" - 20.5"	30 lbs	12 cu ft



A timeless design with bright colors and comfortable cushioning, the Tonik is a chic, eye-catching chair that brings a touch of fun to your office, meeting, or guest space.

STANDARD FEATURES

- Swivel-tilt mechanism with pneumatic height adjustment, single position tilt lock and tension control (1100).
- 5-prong, polished-aluminum base with clear lacquer finish to maintain bright appearance.
- Fully upholstered arms.
- Contoured wood frame shell for strength and support.
- 2" dual wheel carpet casters (1100).
- Steel tubular frame with rear angled legs for stability with chrome finish for durability (1101).
- ANSI/BIFMA approved and TB117-2013 compliant.

GENERAL INFORMATION

- Upholstery (All Models): 2 yd/chair



Tonik 1100



Tonik 1101

Model	Description	1	2	3	4	5	6	7	8	Leather Plus	Madras Leather	Princess Leather
1100	Designer Chair	1385	1454	1511	1567	1638	1709	1779	1850	1567	1962	2111
1101	4-Legged	1385	1454	1511	1567	1638	1709	1779	1850	1567	1962	2111



1100

OPTIONS

Description	Suffix	Models	Upcharge
Hard Surface Casters	TC	1100	85

DIMENSIONS

Model	Overall Width	Overall Depth	Overall Height	Seat Height	Weight	Volume
1100	24"	28.5"	36" - 39.5"	18" - 24.5"	40 lbs	14 cu ft
1101	24"	28"	36"	18"	35 lbs	12 cu ft



The Danforth II Series brings a classic and refined look to your lounge space. Its modular construction is easy to move, repair, and assemble. No tools required. The Danforth is a versatile solution for all lounge seating needs.

STANDARD FEATURES

- Modular construction.
- High density foam for durability and comfort.
- Components are easily replaceable.
- No tools required, parts slide together like a bed frame.
- Black plastic glides.
- ANSI/BIFMA approved and TB117-2013 compliant.

GENERAL INFORMATION

- Upholstery:
 - Model 1221 - 6 yd/chair
 - Model 1222 - 9 yd/chair
 - Model 1223 - 13 yd/chair
- Please specify outlet location for EL option
 - *EL-RH for right handed sitter*
 - *EL-LH for left handed sitter*



Danforth II 1221-CH



EL



1221-EL-RH-CH

Modular System:

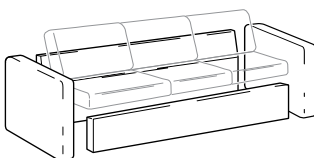

1221-CH-ATL

Model	Description	1	2	3	4	5	6	7	8	Leather Plus	Madras Leather	Princess Leather
1221	Modular Club Chair	1962	2340	2569	2851	3148	3444	3741	4037	2879	3944	4918
1222	Modular Two Seater Sofa	2865	3267	3684	4086	4488	4890	5293	5695	4121	5172	6182
1223	Modular Three Seater Sofa	3704	4255	4790	5364	5905	6451	6993	7536	5413	6450	7990



1221



1222-CH



1223-CH



1221-MF-CH



1221-CH



1221-RD-CH

OPTIONS

Description	Suffix	Models	Upcharge
Brushed Aluminum Legs	CH	All Models	204
Right Handed Swivel Tablet Top (<i>Black laminate</i>)	ATR	All Models	685
Left Handed Swivel Tablet Top (<i>Black laminate</i>)	ATL	All Models	685
Modern Flaired Arm / Rolled Arm Option	MF / RD	All Models	213
Electrical / USB Port (Specify LH or RH as per general info.) 10 Foot Cord	EL	All Models	353
Braking Casters (Front & Back)	BRK	All Models	213

DIMENSIONS

Model	Overall Width	Overall Depth	Overall Height	Seat Height	Weight	Volume
1221	32"	32"	27.5"	17"	95 lbs	12 cu ft
1222	56"	32"	27.5"	17"	135 lbs	23 cu ft
1223	80"	32"	27.5"	17"	174 lbs	28 cu ft

Sleek never goes out of style. The Lakeshore's striking, tailored lines and low back make it a statement piece.

STANDARD FEATURES

- The Lakeshore series is modular by design. The arms, back and seat are built separately and fastened securely together after being upholstered.
- Featuring high density, high resiliency foam over elastic webbing on ¾" hardwood plywood frame.
- The steel base frame is finished with a high-impact silver epoxy powder coat, electrostatically applied for corrosion resistance.
- Environmental sustainability is a key. The steel frame is recyclable. Upholstery is easily removable. Foam is CFC free.
- The design is great for professional and creative working environments.
- Lakeshore is available as a single, double or triple seater.
- ANSI/BIFMA approved and TB117-2013 compliant.

GENERAL INFORMATION

- Upholstery:
 - Model 1301 - 6.5 yd/chair
 - Model 1302 - 9 yd/chair
 - Model 1303 - 12 yd/chair
- Patented Design.



Lakeshore 1303



Lakeshore 1301

Model	Description	1	2	3	4	5	6	7	8	Leather Plus	Madras Leather	Princess Leather
1301	Club Chair	3050	3346	3643	3939	4234	4531	4827	5124	3959	4878	6035
1302	2 Seat Sofa	3741	4185	4630	5075	5520	5964	6408	6854	5118	6557	8392
1303	3 Seat Sofa	4511	5104	5697	6289	6882	7474	8067	8659	6339	8081	10373



1301



1302



1303

DIMENSIONS

Model	Overall Width	Overall Depth	Overall Height	Seat Height	Weight	Volume
1301	39"	34"	29"	18.5"	119 lbs	20 cu ft
1302	68"	34"	29"	18.5"	159 lbs	34 cu ft
1303	92.5"	34"	29"	18.5"	199 lbs	46 cu ft

Geometric and funky, the Joey's many configurations allow you to get creative in transforming your space. Great for lounge and collaborative spaces.

STANDARD FEATURES

- Modular, armless lounge bench with unique geometric shape.
- Fully upholstered seat.
- High-density, high-resiliency foam for comfort and support.
- Tapered with high-impact, silver epoxy powder coat paint, electro-statically applied for corrosion resistance.
- The design is great for public and institutional environments.
- ANSI/BIFMA approved and TB117-2013 compliant.

GENERAL INFORMATION

- Upholstery:
 - Model 1310 - 2.75 yd/chair
 - Model 1311 - 2.75 yd/chair



Joey 1310 (3 units)



Joey 1310 (3 units)

Model	Description	1	2	3	4	5	6	7	8	Leather Plus	Madras Leather	Princess Leather
1310	Modular Bench	2894	3028	3162	3297	3430	3565	3698	3833	3311	3656	3811
1311	Straight Bench	2746	2887	3014	3148	3282	3416	3551	3684	3162	3508	3720



1310



1311



3 Units in different configurations shown in above images.

DIMENSIONS

Model	Overall Width	Overall Depth	Overall Height	Seat Height	Weight	Volume
1310	44"	33"	18.5"	18.5"	60 lbs	20 cu ft
1311	48"	33"	18.5"	18.5"	60 lbs	20 cu ft

Stephanie

1400

The Stephanie is a square, streamlined chair perfect for smaller collaboration and guest spaces. Mix-and-match to brighten up your space. The Stephanie is versatile, stylish, and fun.

STANDARD FEATURES

- Plywood construction for strength.
- Polished aluminum legs for elegant finished look.
- Fully upholstered seat and back. Available in two-tone upholstery.
- High-density, high-resiliency seat and back foam for comfort and support.
- The design is great for public and institutional environments.
- ANSI/BIFMA approved and TB117-2013 compliant.

GENERAL INFORMATION

- Upholstery:
 - Model 1401 - 3.5 yd/chair
 - Model 1410 - 2.5 yd/chair



Stephanie 1401

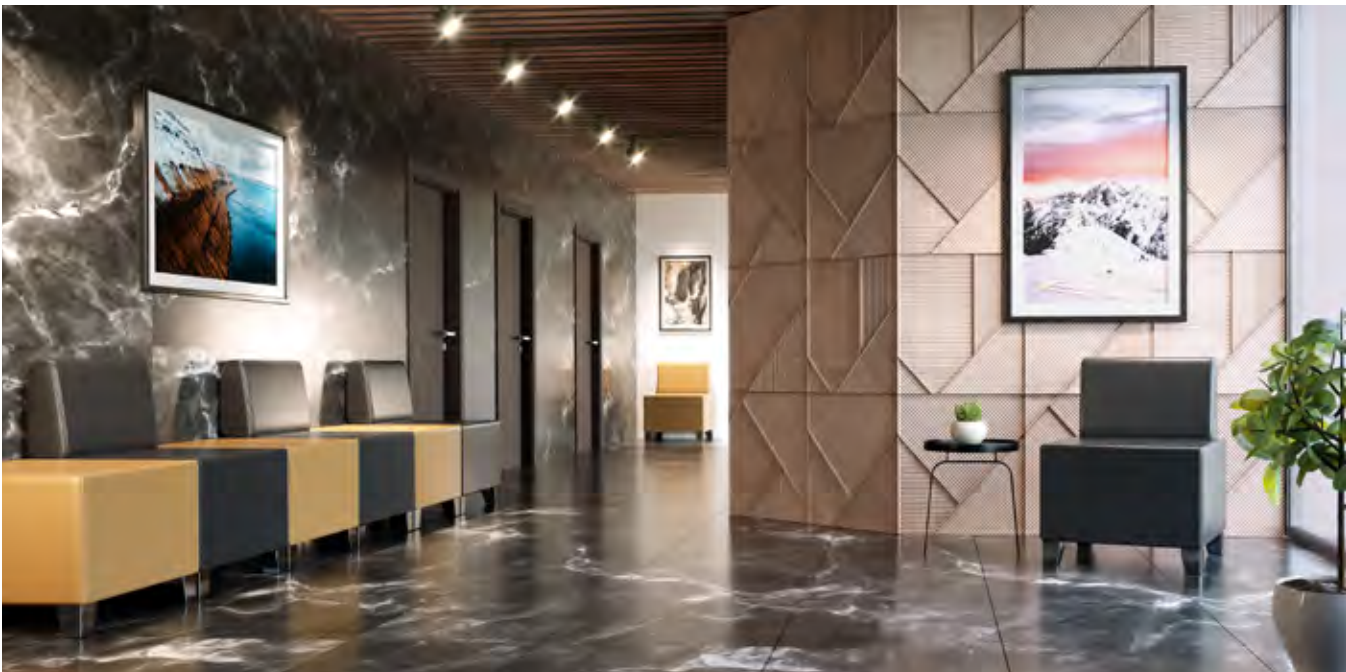

Stephanie 1401-DT, 1410, 1401

Model	Description	1	2	3	4	5	6	7	8	Leather Plus	Madras Leather	Princess Leather
1401	Lounge Seating with Back Rest	1448	1590	1702	1828	1956	2082	2210	2337	1842	2267	2591
1410	Lounge Seating	1264	1350	1434	1518	1603	1688	1772	1857	1533	1828	2082



1401



1410



1412

OPTIONS

Description	Suffix	Models	Upcharge
Dual Tone Upholstery*	DT	1401	0
Ganging	GANG	1401, 1410	107

*When selecting Dual Tone Upholstery chair will be graded in the higher of two textiles selected.



3 possible configurations shown in above images.

DIMENSIONS

Model	Overall Width	Overall Depth	Overall Height	Seat Height	Weight	Volume
1401	24"	24"	30.5"	18"	42 lbs	14 cu ft
1410	24"	24"	18"	18"	31 lbs	14 cu ft

Mikey

1500

The Mikey is an exquisite lounge piece with its round shape and sleek chrome trumpet base. It elevates the mood in any space with its playful, retro aesthetic.

STANDARD FEATURES

- Fully upholstered steel frame capsulated over molded foam.
- Swivel mechanism featuring a fixed height pneumatic cylinder.
- Chrome plated trumpet base.
- High-density, high-resiliency molded foam for comfort and support.
- ANSI/BIFMA approved and TB117-2013 compliant.

GENERAL INFORMATION

- Upholstery: 2.5 yd/chair



Mikey 1500



Mikey 1500

Model	Description	1	2	3	4	5	6	7	8	Madras Leather	Princess Leather
1500	Lounge Seat	1624	1714	1810	1899	1992	2081	2174	2266	2252	2492



1500



1500-04

OPTIONS

Description	Suffix	Models	Upcharge
Polished Aluminum Four Prong Base	04	1500	-50
Pneumatic Lift	GL	1500	107

DIMENSIONS

Model	Overall Width	Overall Depth	Overall Height	Seat Height	Weight	Volume
1500	28"	26"	29"	18½"	30lbs	18 cu ft

With its thoughtfully modelled contours and simplicity of form, the Johnny elevates its environment. Comfortable and functional, it's a premium take on the conventional guest chair.

STANDARD FEATURES

- Fully upholstered steel frame design for strength and durability.
- 4-prong polished aluminum base with non-marking nylon base leg glides to protect floor surface (1509).
- High-density, high-resiliency foam for comfort and support.
- Swivel mechanism.
- ANSI/BIFMA approved and TB117-2013 compliant.

GENERAL INFORMATION

- Upholstery: 2.5 yd/chair



Johnny 1509-TP



Johnny 1509

Model	Description	1	2	3	4	5	6	7	8	Madras Leather	Princess Leather
1509	Lounge/Guest Chair	1700	1793	1885	1976	2067	2160	2252	2344	2330	2569
1501	4-Legged Chair	1700	1793	1885	1976	2067	2160	2252	2344	2330	2569
1550	4-Legged Chair	1755	1810	1865	1920	1975	2030	2085	2140	2195	2250



1501



1509



1509-TP



1550

OPTIONS

Description	Suffix	Models	Upcharge
Chrome Plated Trumpet Base	TP	1509	71
Pneumatic Lift	GL	1509	107
Jury Base	JB	1509	225

DIMENSIONS

Model	Overall Width	Overall Depth	Overall Height	Seat Height	Weight	Volume
1509	25.5"	30"	30"	17"	29 lbs	18 cu ft

The Legacy is a “do-it-all” task chair that keeps you comfortable and focused all day. With its mid-sized back, adjustable arms, and smooth fabric upholstery, it is an office chair to suit anyone.

STANDARD FEATURES

- Swivel-tilt mechanism featuring infinite tilt lock, pneumatic seat height adjustment and tension control.
- Seat slider for seat depth adjustment.
- Ratcheted back height adjustment.
- Patented internal lumbar back support that self-adjusts to the user’s back, providing incredible lateral support while offering excellent pelvic stability.
- Contoured molded seat foam incorporates a “waterfall” design that gently slopes away from the legs, minimizing pressure on the thighs while promoting correct posture.
- Height and width adjustable arms.
- Lockable pivoting polyurethane arm pad.
- Injection molded back shroud on back post for improved aesthetics.
- 5 prong heavy duty nylon base.
- 2” dual wheel carpet casters.
- Mechanism, base, casters and trim standard in black.
- High-density, high-resiliency molded back and seat foam for added durability and comfort.
- ANSI/BIFMA approved and TB117-2013 compliant.

GENERAL INFORMATION

- Upholstery (All Models): 2 yd/chair
- If DS option is selected the chair will not tilt.

PATENTED DESIGN



Internal lumbar and lateral back support that adjusts to the users back for personalized support and comfort.



Legacy 1650

RATED FOR



Legacy 1600D-TC

Model	Description	1	2	3	4	5	6	7	8	Madras Leather	Princess Leather
1600D	High Back Ergonomic	1665	1743	1821	1899	1976	2053	2131	2209	2138	2272
1600	Mid Back Ergonomic	1595	1673	1751	1828	1907	1983	2062	2138	2068	2202
1650	Low Back Ergonomic	1567	1644	1723	1800	1878	1955	2033	2110	2040	2174



OPTIONS

Description	Suffix	Models	Upcharge
Enersorb Foam Seat	E	All Models	106
3" Carpet Casters	LG	All Models	85
2" Hard Surface Casters	TC	All Models	85
3" Hard Surface Casters	TC3	All Models	149
Armless	07	All Models	-120
Sit / Stand Drafting Stool (No tilt with Stool option)	DS	1600D, 1600, 1650	92

DIMENSIONS

Model	Overall Width	Overall Depth	Overall Height	Seat Height	Weight	Volume
1600D	28.5"- 32"	27"	44"- 49.5"	16"- 21.5"	60 lbs	8.5 cu ft
1600	26.5"- 29.5"	27"	38"- 45.5"	16"- 21.5"	56 lbs	8.5 cu ft
1650	27" - 29.5"	23"	27.5"	16"- 21.5"	55 lbs	8.5 cu ft

The Soda provides a classic look and a cozy sit. This retro model celebrates our history of design quality. It is chic and colorful, made to brighten up work and guest spaces.

STANDARD FEATURES

- Swivel-tilt mechanism with pneumatic height adjustment, single position tilt lock and tension control (1700).
- 5 prong polished aluminum base with clear lacquer finish to maintain bright appearance (1700).
- Fully upholstered.
- Contoured wood frame shell for strength and support.
- 2" dual wheel carpet casters (1700).
- Steel tubular frame with rear angles legs for stability with chrome finish for durability (1701).
- ANSI/BIFMA approved and TB117-2013 compliant.

GENERAL INFORMATION

- Upholstery (All Models): 2 yd/chair



Soda 1700



Soda 1701

Model	Description	1	2	3	4	5	6	7	8	Leather Plus	Madras Leather	Princess Leather
1700	Soda Designer Chair	1404	1454	1517	1581	1644	1709	1771	1836	1581	1793	1934
1701	Soda 4-Legged	1404	1454	1517	1581	1644	1709	1771	1836	1581	1793	1934



1700



1701

OPTIONS

Description	Suffix	Models	Upcharge
2" Hard Surface Casters	TC	1700	85

DIMENSIONS

Model	Overall Width	Overall Depth	Overall Height	Seat Height	Weight	Volume
1700	24"	27"	35"- 38.5"	16"- 20"	36 lbs	12 cu ft
1701	24"	27"	31"	18"	31 lbs	12 cu ft

The surgeon console is engineered to provide individual comfort and support for long periods of time. Based on the Health Care Industry's main requirements, the Surgeon Console is easy to clean and built to last.

STANDARD FEATURES

- Self-adjusting, concave armrests built into back with spring system to allow automatic adjustment for each individual user.
- High-resiliency molded foam for comfort and durability.
- ENERSORB™ seat foam to reduce sitting fatigue by reducing pressure points and increasing blood circulation.
- Built-in ratchet back height adjustment.
- Swivel mechanism with free float or variable back angle adjustment, pneumatic height adjustment, and seat slide for seat depth adjustment (1864).
- 2" black, dual wheel, non-marking, hooded polyurethane hard surface casters.
- Model 1864DS - Swivel mechanism featuring foot ring height adjustment and seat slider for seat depth adjustment.
- 5 prong, polished aluminum base with clear lacquer finish to maintain bright appearance.
- ANSI/BIFMA approved and TB117-2013 compliant.

GENERAL INFORMATION

- Upholstery (All Models): 2 yd./chair
- Patented Design.

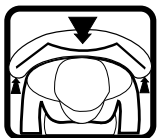

PATENTED:
Internal lumbar and lateral back support that adjusts to the users back for personalized support and comfort.



Surgeon Console 1864



Surgeon Console 1864

Model	Description	1	2	3	4	5	6	7	8	Madras Leather	Princess Leather
1864	Mid Back Task	1697	1771	1841	1905	1976	2047	2117	2188	2131	2272



1864



1864-DS

OPTIONS

Description	Suffix	Models	Upcharge
Stand to Lock Casters	LC	All Models	78
Sit to Lock Casters (when seated)	RLC	All Models	78
Sit / Stand Drafting Stool	DS	All Models	134

DIMENSIONS

Model	Overall Width	Overall Depth	Overall Height	Seat Height	Weight	Volume
1864	25"	25"-27"	36"- 43"	17"- 22.5"	44 lbs	14 cu ft
1864DS	25"	25"-27"	40.5"- 48"	22.5"- 30"	49 lbs	14 cu ft

Inspired by the striking cliffs of the Amalfi coast in Italy, The Amalfi is a sleek chair that brings a touch of the seaside to your office space. The Amalfi is a fresh take on the classic executive task seat.

STANDARD FEATURES

- Swivel mechanism with pneumatic height adjustment (1900).
- Swivel-tilt mechanism with single position lock up right and tension control (1900TL).
- Stylish wishbone design for dramatic appearance (1900).
- High-density, high-resiliency seat and back foam for comfort and support.
- Contoured, molded plywood shell for strength.
- 2" chrome plated, dual carpet casters.
- Polished aluminum legs and chrome plated arms.
- ANSI/BIFMA approved and TB117-2013 compliant.

GENERAL INFORMATION

- Upholstery: 2 yd/chair



Amalfi 1900TL



Amalfi 1900TL

Model	Description	1	2	3	4	5	6	7	8	Leather Plus	Madras Leather	Princess Leather
1900	Mid Back Conference	1447	1531	1624	1709	1793	1885	1969	2053	1709	1913	2062
1900TL	Mid Back Conference Tilt Lock	1517	1602	1695	1779	1863	1955	2039	2123	1779	1983	2123



1900



1900TL

OPTIONS

Description	Suffix	Models	Upcharge
2" Hard Surface Casters	TC	All Models	85

DIMENSIONS

Model	Overall Width	Overall Depth	Overall Height	Seat Height	Weight	Volume
1900	24.5"	26"	35"-37.25"	17"-19.5"	32 lbs	17 cu ft
1900TL	24.5"	26"	37"-39.5"	17.5"-20"	38 lbs	17 cu ft

The Stratford is a fully upholstered comfortable lounge chair. Its integrated headrest provides optimal support for your whole body. Made for reading files or just taking a break, the Stratford brings living-room comfort into your office space.

STANDARD FEATURES

- Molded high density foam.
- Fully upholstered seat and back, allows for dual-tone upholstery for comfort and support.
- Swivel tilt lock mechanism with pre-set tension.
- Pneumatic seat height adjustment.
- Contoured, molded plywood shell for strength.
- Polished aluminum 4 star base on glides for added grip and scratch-resistant.
- ANSI/BIFMA approved and TB117-2013 compliant.

GENERAL INFORMATION

- Upholstery:
 - Model 2001 - 6 yd/chair
 - Model 2011 - 1 yd/char



Stratford 2001 & 2011



Stratford 2001 & 2011

Model	Description	1	2	3	4	5	6	7	8	Madras Leather	Princess Leather
2001	High Back Lounge Seat	2533	2674	2900	3126	3351	3578	3804	4029	3776	4404
2011	Ottoman	924	974	1045	1121	1200	1263	1341	1404	1347	1545



2001



2011

OPTIONS

Description	Suffix	Models	Upcharge
Dual Tone Upholstery*	DT	2001	0
Custom Embroidery*	EM	2001	227
Enersorb Foam Topper	E	2001	122

*When selecting Dual Tone Upholstery chair will be graded in the higher of two textiles selected.

*Standard charge for customer embroidery assumes an approved DST file will be provided at time of order placement. If a DST file needs to be created an additional \$300 list fee will apply. Note, there is a minimum order quantity of 8 units.

DIMENSIONS

Model	Overall Width	Overall Depth	Overall Height	Seat Height	Weight	Volume
2001	30"	31.5"	43"	16.5-18.5"	70lbs	N/A
2011	22"	17"	15"	N/A	18lbs	N/A

The Next Level Chair takes comfort and ease of adjustment to a new level. With a family of seating choices, the NLC can outfit every area of today's active office. Great for those who are always on the go, the NLC will take your work day to the next level.

STANDARD FEATURES

- Height adjustable, ergonomically shaped headrest incorporated into the frame of chair for maximum comfort and convenience.
- Built in, height adjustable lumbar support to ease tension in your back.
- Newton Wafer synchro-tilt mechanism: Patent-pending, thin profile mechanism that provides seamless durability and stability, with continuous, even weighted balance through all positions. Integrated seat slide adjustment, multiple position tilt lock, pneumatic seat height adjustment, side tension control.
- Closed loop, polished aluminum arms with polyurethane arm pad for comfort and support.
- Optional flip-up, polished aluminum arm with polyurethane arm pads for easy access, or to allow for utility belts. Arm easily clicks into vertical or horizontal position.
- Optional 4D adjustable polished aluminum arms with lockable, vertical arm and horizontal, lateral and pivoting arm pad movement, arm pad made with polyurethane surface for comfort and support.
- Swivel mechanism with pneumatic height adjustment (When selecting DS Option).
- Height adjustable, heavy-duty foot ring (When selecting DS Option).
- High-density, high-resiliency molded foam for support and durability.
- 5-prong, heavy-duty polished aluminum base.
- 2.5" translucent carpet casters.
- ANSI/BIFMA approved and TB117-2013 compliant.

GENERAL INFORMATION

- Upholstery: 2 yd/chair



NLC 2020D-FL

RATED FOR
350lbs



NLC 2020D

Model	Description	1	2	3	4	5	6	7	8	Leather Plus	Madras Leather	Princess Leather
2020D	High Back Executive	1969	2047	2118	2195	2272	2344	2421	2506	2195	2258	2443
2020	Mid Back Conference	1827	1905	1976	2053	2131	2202	2280	2364	2053	2117	2301



NLC 2020

OPTIONS

Description	Suffix	Models	Upcharge
Flip-up Arm	FL	All Models	57
4D Adjustable Arm	A	All Models	57
3" Hard Surface Casters	TC3	All Models	149
3" Carpet Casters	LG	All Models	85
Enersorb Foam	E	All Models	57
Sit/ Stand Drafting Stool (Standard with 8" Gas Lift)	DS	All Models	204
Custom Embroidery*	EM	2020D	227

*Standard charge for customer embroidery assumes an approved DST file will be provided at time of order placement. If a DST file needs to be created an additional \$300 list fee will apply. Note, there is a minimum order quantity of 8 units.

DIMENSIONS

Model	Overall Width	Overall Depth	Overall Height	Seat Height	Weight	Volume	KD Volume	Base Dia.
2020D	26"	25"	47" - 52.5"	16.5" - 21"	77 lbs	19 cu ft	16 cu ft	26.5"
2020	26"	25"	38" - 42.5"	16.5" - 21"	70 lbs	16 cu ft	16 cu ft	26.5"

The Bless is an ergonomic task chair that is high performing but reasonably priced. With its breezy back and easy adjustments, the Bless is a perfect choice for modern workstations.

STANDARD FEATURES

- Translucent patterned weave, responsive mesh back creates a contoured shape that provides perfect support for all users automatically.
- Self-weighted mechanism for the perfect tension control with tilt lock, pneumatic height adjustment, and built-in seat slide controller.
- 4-way height and width adjustable arms with arm pad front and back adjustment and arm pivot adjustment for full-range movement.
- Height adjustable lumbar support.
- High density, high resiliency seat foam.
- Five prong heavy duty nylon base.
- 2" dual-wheel carpet casters.
- Optional adjustable mesh headrest with height and angle adjustment.
- ANSI/BIFMA approved and TB117-2013 compliant.

GENERAL INFORMATION

- Upholstery:
 - Model 2100 - 1 yd/chair
 - Model 2100D - 1 yd/chair

RATED FOR

300lbs



Bless 2100 & 2100D



Bless 2100D

Model	Description	1	2	3	4	5	6	7	8	Madras Leather	Princess Leather
2100	Mesh Back with Upholstered Seat	953	982	1023	1066	1108	1150	1192	1234	1116	1219
2100D	Mesh Back with Headrest & Upholstered Seat	1080	1108	1150	1192	1236	1278	1320	1361	1243	1346



2100



2100D

OPTIONS

Description	Suffix	Models	Upcharge
3" Carpet Casters	LG	2100 & 2100D	85
2" Hard Surface Casters	TC	2100 & 2100D	85
3" Hard Surface Casters	TC3	2100 & 2100D	149
Armless	07	2100 & 2100D	-50
Enersorb Foam Seat	E	2100 & 2100D	106
Polished Aluminum Base	CH	2100 & 2100D	141
Sit/Stand Stool - Swivel mechanism with pneumatic height adjustment and seat slide adjustment	DS	2100 & 2100D	78

DIMENSIONS

Model	Overall Width	Overall Depth	Overall Height	Seat Height	Weight	Volume cu ft
2100	26"	26.50"	42.75"	16.50-21.50"	47 lbs	14
2100D	26"	26.50"	51.75"	16.50-21.50"	49 lbs	14

The Malibu is a lightweight chair that brings a touch of breezy beach life into your office. With its ease of movement and ultra-breathability, it helps you stay cool, calm, and collected, no matter what the day brings.

STANDARD FEATURES

- Perforated polypropylene plastic back for aeration and flexibility.
- Self-weighted mechanism for the perfect tension control with tilt lock, pneumatic height adjustment, and built-in seat slide controller.
- 4-way height and width adjustable arms with arm pad front and back adjustment and arm pivot adjustment for full-range movement.
- High density, high resiliency seat foam.
- Five prong heavy duty nylon base.
- 2" dual-wheel carpet casters.
- ANSI/BIFMA approved and TB117-2013 compliant.

GENERAL INFORMATION

- Upholstery: 1 yd/chair



Malibu 2200



Malibu 2200

Model	Description	1	2	3	4	5	6	7	8	Madras Leather	Princess Leather
2200	Mid-Back Plastic Mesh Chair	918	946	988	1031	1072	1116	1159	1200	1080	1173



2200

OPTIONS

Description	Suffix	Models	Upcharge
3" Carpet Casters	LG	2200	85
2" Hard Surface Casters	TC	2200	85
3" Hard Surface Casters	TC3	2200	149
Armless	07	2200	-50
Enersorb Foam Seat	E	2200	106
Polished Aluminum Base	CH	2200	141
Sit/Stand Stool - Swivel mechanism with pneumatic height adjustment and seat slide adjustment	DS	2200	78

DIMENSIONS

Model	Overall Width	Overall Depth	Overall Height	Seat Height	Weight	Volume
2200	26"	26.50"	40.75"	16.50-21.50"	46 lbs	14

The Frio is built for long-lasting comfort and simplicity of style. Its many adjustable components help you find your groove and feel supported throughout the day. It has your back.

STANDARD FEATURES

- Ratchet adjustable back height with built in lumbar support.
- Self-weighted mechanism for the perfect tension control with tilt lock, pneumatic height adjustment, and built-in seat slide controller.
- 4-way height and width adjustable arms with arm pad front and back adjustment and arm pivot adjustment for full-range movement.
- High density, high resiliency seat and back foam.
- Five prong heavy duty nylon base.
- 2" dual-wheel carpet casters.
- Optional adjustable headrest with height and angle adjustment.
- ANSI/BIFMA approved and TB117-2013 compliant.

GENERAL INFORMATION

- Upholstery:
 - Model 2300 - 2 yd/chair
 - Model 2300D - 2 yd/chair



Frio 2300

RATED FOR

300lbs



Frio 2300D

Model	Description	1	2	3	4	5	6	7	8	Madras Leather	Princess Leather
2300	Fully Upholstered High-Back	1108	1159	1248	1334	1404	1503	1588	1673	1560	1792
2300D	Fully Upholstered High-Back with Headrest	1285	1334	1426	1511	1581	1679	1765	1850	1737	1976



2300



2300D

OPTIONS

Description	Suffix	Models	Upcharge
3" Carpet Casters	LG	2300 & 2300D	85
2" Hard Surface Casters	TC	2300 & 2300D	85
3" Hard Surface Casters	TC3	2300 & 2300D	149
Armless	07	2300 & 2300D	-50
Enersorb Foam Seat	E	2300 & 2300D	106
Polished Aluminum Base	CH	2300 & 2300D	141
Sit/Stand Stool - Swivel mechanism with pneumatic height adjustment and seat slide adjustment	DS	2300 & 2300D	78
Custom Embroidery*	EM	2300D	227

**Standard charge for customer embroidery assumes an approved DST file will be provided at time of order placement. If a DST file needs to be created an additional \$300 list fee will apply. Note, there is a minimum order quantity of 8 units.*

DIMENSIONS

Model	Overall Width	Overall Depth	Overall Height	Seat Height	Weight	Volume cu ft
2300	26"	26.50"	45"	16.50-21.50"	53 lbs	16
2300D	26"	26.50"	55"	16.50-21.50"	55 lbs	16

The Trullo provides semi-private seating with fully upholstered, high back and side panels. Available in solid or dual-tone upholstery with optional built-in power/USB socket, its a workstation and a chair, all in one. Find your focus.

STANDARD FEATURES

- Modular construction.
- High-density, high-resiliency seat and back foam for comfort and support.
- No tools required. Parts slide together like a bed frame.
- Molded plywood shell for strength.
- Polished aluminum legs.
- ANSI/BIFMA approved and TB117-2013 compliant.

GENERAL INFORMATION

- Upholstery:
 - Model 3001 - 9 yd/chair
 - Model 3002 - 12 yd/chair
 - Model 3003 - 14 yd/chair
 - Model 3022 (Single Bench) - 2 yd/unit
 - Model 3047 (Double Bench) - 3 yd/unit
 - Model 3032 (Center Table) - 2 yd/unit
- Two-Tone Upholstery:
 - Model 3001 - Outer 6 yd, Inner 5 yd
 - Model 3002 - Outer 8 yd, Inner 6 yd
 - Model 3003 - Outer 10 yd, Inner 8 yd
- Please specify outlet location for EL option
 - *EL-RH for right handed sitter*
 - *EL-LH for left handed sitter*
- Note: Electrical Port consists of:
 - 1 Electrical Outlet
 - 2 USB Ports
 - Rating: AC 125V, 60Hz, 15A
 - USB Outputport: DC 5v, 4 2A
 - Power Cord Length: 6 feet



Trullo 3001-DT-EL, 3032



Trullo 3001-DT-EL

Model	Description	1	2	3	4	5	6	7	8	Madras Leather	Princess Leather
3001	One Seater	3732	4015	4495	4976	5455	5935	6414	6894	6457	7826
3002	Two Seater	4777	5153	5780	6408	7035	7664	8291	8921	8347	10141
3003	Three Seater	5858	6295	7030	7762	8496	9231	9965	10700	10014	12117
3022	Single Bench	1121	1186	1278	1385	1483	1581	1679	1779	1687	1948
3047	Double Bench	1404	1475	1610	1737	1864	1992	2117	2244	2146	2392
3032	Upholstered Table	1545	1595	1665	1737	1807	1878	1948	2019	1962	2174



3001-EL



3002



3003



3032



3022



3047

OPTIONS

Description	Suffix	Models	Upcharge
Dual Tone Upholstery*	DT	3001, 3002, 3003, 3022, 3047	0
Electrical Port (Specify LH or RH as per general info.)	EL	3001, 3002, 3003	353

*When selecting Dual Tone Upholstery chair will be graded in the higher of two textiles selected.

DIMENSIONS

Model	Overall Width	Overall Depth	Overall Height	Seat Height	Weight
3001	37"	31"	48"	18.5"	120 lbs
3002	55"	31"	48"	18.5"	160 lbs
3003	79.5"	31"	48"	18.5"	215 lbs
3022	22"	22.5"	18.5"	18.5"	40 lbs
3032	32"	32"	16"	N/A	95 lbs
3047	47"	22.5"	18.5"	18.5"	65 lbs

Ergo-Learn is an ergonomic, multi-task chair. Its straightforward design and versatility make it ideal for the requirements of an active work environment.

STANDARD FEATURES

- Swivel tilt mechanism with infinite position tilt lock.
- Seat slider and back angle adjustment.
- 6° forward tilt adjustment, back height adjustment, pneumatic height adjustment and tension control.
- Horizontal and vertical adjustable arms.
- Built-in lumbar support for proper posture and ergonomic support.
- Waterfall seat design to reduce muscle fatigue.
- ENERSORB™ seat foam provides optimal support all day long.
- 5-prong, heavy-duty nylon base with 2" carpet casters.
- ANSI/BIFMA approved and TB117-2013 compliant.

GENERAL INFORMATION

- Upholstery: 2 yd/chair



Ergo-Learn 3280-TC

RATED FOR

300lbs



Ergo-Learn 3285-TC

Model	Description	1	2	3	4	5	6	7	8	Leather Plus	Madras Leather	Princess Leather
3280D	Large Task Chair	1298	1362	1418	1474	1539	1602	1665	1729	1484	1737	1887
3280	Medium Task Chair	1228	1285	1349	1404	1469	1531	1595	1659	1414	1666	1810
3285	Small Task Chair	1200	1257	1320	1376	1440	1503	1567	1630	1386	1638	1782



3280D



3280



3285

OPTIONS

Description	Suffix	Models	Upcharge
3" Carpet Casters	LG	All Models	85
2" Hard Surface Casters	TC	All Models	85
3" Hard Surface Casters	TC3	All Models	149
Armless	07	All Models	-125

DIMENSIONS

Model	Overall Width	Overall Depth	Overall Height	Seat Height	Weight	Volume
3280D	26.5"- 30"	26.5"	41.5"-49"	17"-22.5"	57 lbs	14 cu ft
3280	25"-29"	26.5"	35.25"-42.75"	17"-22.5"	49 lbs	14 cu ft
3285	23.5"-27.5"	26.5"	33.75"-41.25"	17"-22.5"	47 lbs	14 cu ft

An affordable, premium executive chair, the Khroma combines ergonomic support with exceptional styling. Its high-powered finish and comfortable seat lend a presidential feel to your office space.

STANDARD FEATURES

- Knee-tilt swivel mechanism (3400D), dual-position tilt lock, pneumatic height adjustment, and tension control.
- Energy absorbing ENERSORB™ seat foam conforms to your body and disperses your weight ergonomically to improve blood circulation and relieve pressure points.
- Ergonomically contoured back with ENERSORB™.
- Chrome plated arm rests with upholstered arm pads for comfort.
- 5-prong, polished-aluminum base with clear lacquer finish to maintain bright appearance.
- 2" dual wheel carpet casters.
- ANSI/BIFMA approved and TB117-2013 compliant.

GENERAL INFORMATION

- Upholstery: 3 yd/chair
- **Note:** A pillow upholstery technique is used with vinyl, leather or leather plus to provide a wrinkled, plush appearance.



Khroma 3400D



Khroma 3400D-TC

Model	Description	1 Vinyl	4 Vinyl or Leather Plus	5 Vinyl	6 Vinyl	Madras Leather	Princess Leather
3400D	High Back Executive	1234	1447	1602	1751	1737	2138



3400D

OPTIONS

Description	Suffix	Models	Upcharge
3" Carpet Casters	LG	3400D	85
2" Hard Surface Casters	TC	3400D	85
3" Hard Surface Casters	TC3	3400D	149
Urethane Arms (Black Urethane Arms & Base)	UR	3400D	57
Custom Embroidery*	EM	3400D	227

**Standard charge for customer embroidery assumes an approved DST file will be provided at time of order placement. If a DST file needs to be created an additional \$300 list fee will apply. Note, there is a minimum order quantity of 8 units.*

DIMENSIONS

Model	Overall Width	Overall Depth	Overall Height	Seat Height	Weight	Volume	KD Volume
3400D	25"	28"	42"- 45"	17.5"- 21.5"	50 lbs	17 cu ft	16 cu ft

Tuxedo provides a contemporary touch to office and meeting spaces. With its glossy upholstery and high degree of mobility, it offers a polished look.

STANDARD FEATURES

- Energy absorbing ENERSORB™ seat foam conforms to your body and disperses your weight ergonomically to improve blood circulation and relieve pressure points.
- Synchronous tilt mechanism with single position tilt lock and tension control.
- Height adjustable arms with polyurethane arm pads.
- Contoured back for added lateral back support.
- 5-prong, heavy-duty nylon base.
- 2" dual wheel carpet casters.
- ANSI/BIFMA approved and TB117-2013 compliant.

GENERAL INFORMATION

- Upholstery: 2 yd/chair
- Finish: mechanism, arms, base, casters and trim standard in black.
- **Note:** A pillow upholstery technique is used with vinyl, leather or leather plus to provide a wrinkled, plush appearance.



Tuxedo 3500-TC-CH



Tuxedo 3500-TC

Model	Description	1 Vinyl	4 Vinyl or Leather Plus	5 Vinyl	6 Vinyl	Madras Leather	Princess Leather
3500	Mid Back	1263	1531	1651	1765	1651	1779



3500



3500-07

OPTIONS

Description	Suffix	Models	Upcharge
Polished Aluminum Base	CH	All Models	71
Auto-Return Gas Lift (<i>Seat height range 16" - 18.5"</i>)	MR	All Models	92
3" Carpet Casters	LG	All Models	84
2" Hard Surface Casters	TC	All Models	43
3" Hard Surface Casters	TC3	All Models	149
Armless	07	All models	-105

DIMENSIONS

Model	Overall Width	Overall Depth	Overall Height	Seat Height	Weight	Volume
3500	25"	25"	36" - 43"	17" - 22.5"	44 lbs	14 cu ft

Ultima II is ideal for office settings. Its compact frame makes it especially useful for smaller work areas, and its reinforced frame supports up to 300 lbs.

STANDARD FEATURES

- Swivel & pneumatic height adjustment (3600D, 3607, 3600, 3605).
- Pneumatic height adjustment, seat depth adjustment with swivel mechanism for (3600DS, 3600D-DS).
- Waterfall seat design to reduce muscle fatigue.
- High density foam for support and durability.
- Soft curved back with built in lumbar support for ergonomic comfort.
- 5-prong, heavy-duty nylon base.
- 2" dual wheel carpet casters.
- Height adjustable arms.
- ANSI/BIFMA approved and TB117-2013 compliant.

GENERAL INFORMATION

- Upholstery: 2 yd/chair
- Finish - mechanism, base, arms, casters and trim standard in black.
- If DS option is selected, chair will not tilt.



Ultima II 3600D-TC

RATED FOR

300lbs



Ultima II 3600D-MT

Model	Description	1	2	3	4	5	6	7	8	Madras Leather	Princess Leather
3600D	High Back Task	922	1008	1075	1158	1236	1311	1388	1463	1364	1516
3600	Mid Back Task	886	967	1037	1121	1198	1273	1351	1427	1326	1473



3600D



3600D-07



3600



3600-07



3600-DS-07

OPTIONS

Description	Suffix	Models	Upcharge
Articulating Swivel Mechanism	AR	3600D, 3607D, 3600, 3600-07	218
Swivel Tilt Lock Mechanism	TL	3600D, 3607D, 3600, 3600-07	141
Width & Height Adjustable Arm w/ Polyurethane Tear Drop Arm Pad	AA	3600D, 3600	156
Multi Tilt Mechanism	MT	All Models	163
3" Carpet Casters	LG	All Models	85
2" Hard Surface Casters	TC	All Models	85
3" Hard Surface Casters	TC3	All Models	149
Armless	07	All Models	-45
Sit / Stand Drafting Stool	DS	All Models	134
Enersorb Foam Seat	E	All Models	114

DIMENSIONS

Model	Overall Width	Overall Depth	Overall Height	Seat Height	Weight	Volume	KD Volume
3600D	25.5"	25.5"	35"- 40.5"	17.5"- 23"	44 lbs	14 cu ft	10 cu ft
3600D-07	25.5"	25.5"	35"- 40.5"	17.5"- 23"	43 lbs	14 cu ft	10 cu ft
3600	25.5"	25.5"	31"- 36.5"	17.5"- 23"	42 lbs	14 cu ft	10 cu ft
3600-07	25.5"	25.5"	31"- 36.5"	17.5"- 23"	42 lbs	12.5 cu ft	10 cu ft
3600-DS-07	20"	25.5"	39"- 47"	22"- 30"	41 lbs	12.5 cu ft	9.6 cu ft

Reward

4800

The Reward is an affordable executive chair that combines ergonomic comfort support with a plush appearance. It is comfortable and stylish, perfect as an office, task, or guest chair.

STANDARD FEATURES

- Swivel tilt mechanism with single position tilt lock, pneumatic height adjustment and tension control (4800D, 4800) (Type 8).
- Pillow upholstery seat and back.
- Steel sled base (4802) available in black Crinkle epoxy powder coat only.
- 5-prong, heavy-duty nylon base.
- 2" dual wheel carpet casters.
- Mechanism, base, casters and trim standard in black.
- Injection molded nylon arm.
- ANSI/BIFMA approved and TB117-2013 compliant.

GENERAL INFORMATION

- Upholstery: 3.75 yd/chair.
- **Note:** A pillow upholstery technique is used with vinyl, leather or leather plus to provide a wrinkled, plush appearance.



Reward 4800D



Reward 4802

Model	Description	1 Vinyl	4 Vinyl or Leather Plus	5 Vinyl	6 Vinyl	Madras Leather	Princess Leather
4800D	High Back Executive	1263	1714	1885	2047	1864	2067
4800	Mid Back Management	1164	1602	1765	1934	1743	1948
4802	Steel Sled Base	1341	1779	1941	2111	1920	2125



4800D



4800



4802

OPTIONS

Description	Suffix	Models	Upcharge
3" Carpet Caster	LG	4800D, 4800	85
2" Hard Surface Casters	TC	4800D, 4800	85
3" Hard Surface Casters	TC3	4800D, 4800	149
Chrome Base	CH	4800D, 4800	141
Custom Embroidery*	EM	4800D	227

**Standard charge for customer embroidery assumes an approved DST file will be provided at time of order placement. If a DST file needs to be created an additional \$300 list fee will apply. Note, there is a minimum order quantity of 8 units.*

DIMENSIONS

Model	Overall Width	Overall Depth	Overall Height	Seat Height	Weight	Volume	KD Volume
4800D	26"	30"	42.5" - 46"	17.5"-21"	55 lbs	19 cu ft	16 cu ft
4800	26"	29"	38"-41.5"	17.5"-21"	53 lbs	17 cu ft	12 cu ft
4802	26"	29"	38.5"	18.5"	51 lbs	17 cu ft	N/A

WXO™ the perfect working chair. It sports a refined, sleek profile with distinctive comfort and support. Its waterfall seat and lumbar support make it a top ergonomic, lightweight task chair.

STANDARD FEATURES

- Translucent ABLEX™ patterned weave mesh back and seat provides generous lumbar and pelvic support while promoting dynamic movement.
 - ENERSORB™ seat foam conforms to your body and disperses your weight ergonomically to improve blood circulation and relieve pressure points (UF & UFST models).
 - Synchronous knee-tilt torsion glide mechanism with preset tension and lock release. Pneumatic seat height adjustment.
 - Contoured waterfall seat design helps to reduce sitting fatigue and promotes good posture.
 - Easy to use height adjustable arms with lockable, pivoting, polyurethane arm pads and manual width adjustment (5800).
 - Graphite frame, base and arms. Black mesh and seat fabric.
 - Optional: White frame with silver mesh and chrome finish.
-
- 5-prong, heavy-duty nylon base.
-
- 2" dual wheel carpet casters.
-
- ANSI/BIFMA approved and TB117-2013 compliant.

GENERAL INFORMATION

- Upholstery:
 - UFST - 1 yd/chair
 - UF - 3 yd/chair
 - Patented Design.
-
- If DS option selected chair will not tilt.



WXO™ 5800M

RATED FOR

300lbs



WXO™ 5800M-CH-TC

Model	Description	Mesh	1	2	3	4	5	6	7	8	Madras Leather	Princess Leather
5800M	Mid Back Task Mesh Seat & Back	1369										
5800UFST	Mid Back Task Upholstered Seat		1517	1575	1630	1687	1743	1800	1855	1913	1807	1885
5800UF	Mid Back Upholstered Seat & Back		1679	1737	1793	1850	1905	1962	2019	2076	1970	2047
5802M	Bow Tie Guest Mesh Seat & Back	1341										
5802UFST	Bow Tie Guest Upholstered Seat		1488	1545	1602	1659	1715	1771	1828	1885	1779	1858
5802UF	Bow Tie Guest Upholstered Seat & Back		1651	1709	1765	1821	1878	1934	1992	2047	1941	2019



5800M



5800UFST



5800UF



5802M-CH



5800M-DS-CH

OPTIONS

Description	Suffix	Models	Upcharge
Silver Mesh Back + Seat	SM	5800M, 5807M, 5802M	149
3" Carpet Caster	LG	5800M, 5800UFST, 5800UF	85
2" Hard Surface Casters	TC	5800M, 5800UFST, 5800UF	85
3" Hard Surface Casters	TC3	5800M, 5800UFST, 5800UF	149
Chrome Finish	CH	5800M, 5800UFST, 5800UF	71
Chrome Frame Finish	CH	5802, 5802UFST, 5802UF	134
Sit / Stand Drafting Stool	DS	5800M, 5800UFST, 5800UF	176
White Frame (Standard silver mesh and polished aluminum base)	WH	All Models	240
Armless	07	All Models	-55
Smaller Seat	S	All Models	0

DIMENSIONS

Model	Overall Width	Overall Depth	Overall Height	Seat Height	Weight	Volume	KD Volume
5800M	26"-28"	25"	36.5"- 40"	16"- 20.5"	40 lbs	16 cu ft	12 cu ft
5800UFST	26"-28"	25"	36.5"- 40"	16"- 20.5"	44 lbs	16 cu ft	12 cu ft
5802UFST	25.5"	24"	35.5"	18"	50 lbs	17 cu ft	14 cu ft
5800-DS	26"-28"	25"	41"- 49"	22"- 30"	50 lbs	16 cu ft	12 cu ft



The MXO™ is an innovative solution for meeting rooms, conference rooms, and training. Its pneumatic gas lift automatically returns the chair to centered position and uniform height when the user stands up.

STANDARD FEATURES

- Translucent ABLEX™ patterned weave, responsive mesh back creates a contoured shape that provides perfect support for all users automatically.
- Ultra-comfortable ENERSORB™ seat foam that allows for greater blood circulation, reducing pressure points.
- Fixed-height arm rests designed to fit under any standard height table.
- Swivel tilt mechanism with gas lift height adjustment and preset tension control.
- Waterfall seat design.
- Memory height and position gas lift which always returns the chair to a uniform height and position.
- 5-prong, heavy-duty nylon base.
- 2" carpet casters.
- Black mesh with graphite finish, frame, arms, base and trim.
- ANSI/BIFMA approved and TB117-2013 compliant.

GENERAL INFORMATION

- Upholstery: 1 yd/chair
- Patented Design.



MXO™ 5900-CH



MXO™ 5900

Model	Description	1	2	3	4	5	6	7	8	Madras Leather	Princess Leather
5900	Mid Back Conference	1159	1214	1271	1320	1376	1433	1488	1545	1440	1508



5900



5900-07

OPTIONS

Description	Suffix	Models	Upcharge
3" Carpet Casters	LG	All Models	85
2" Hard Surface Casters	TC	All Models	85
3" Hard Surface Casters	TC3	All Models	149
Self Locking Casters (When standing)	LC	All Models	71
Polished Aluminum Base	CH	All Models	71
Adjustable Arms	A	All Models	71
Armless	07	All Models	-25

DIMENSIONS

Model	Overall Width	Overall Depth	Overall Height	Seat Height	Weight	Volume	KD Volume
5900	25"	24"	35.5"- 38.5"	17"- 20"	35lbs	14 cu ft	9 cu ft



One chair, multiple functions. Perfect for working, meeting, or training. The LXO's™ lightweight and well-proportioned design is the new standard for ergonomic affordable seating.

STANDARD FEATURES

- ABLEX™ patterned mesh back provides generous lumbar support and dynamic back movement. Air flows freely through this breathable mesh for added comfort.
- Synchro-tilt mechanism with 3 position tilt-lock, pneumatic height adjustment, seat depth adjustment and tension control (6000).
- Swivel mechanism (6000DS) Pneumatic height adjustment, seat depth adjustment and foot ring.
- Black mesh with graphite frame, arms, base and trim.
- Easy to use, height-adjustable arms for individual comfort and support. Arms can be manually adjusted for horizontal width.
- Energy absorbing dual density ENERSORB™ seat foam reduces sitting fatigue.
- Waterfall seat design gently slopes away from the legs, minimizing pressure on the thighs and promoting good posture.
- Model 6002 standard with oval reinforced tubular steel, graphite finish.
- 5-prong, heavy-duty nylon base.
- 2" carpet casters.
- ANSI/BIFMA approved and TB117-2013 compliant.

GENERAL INFORMATION

- Upholstery: 1 yd/chair
- Patented Design.
- If DS option selected, chair will not tilt.



LXO™ 6000-CH

RATED FOR



LXO™ 6000

Model	Description	1	2	3	4	5	6	7	8	Madras Leather	Princess Leather
6000	Mid Back Task	1257	1320	1385	1433	1497	1558	1624	1687	1560	1638
6002	Mid Back Sled	1257	1320	1385	1433	1497	1558	1624	1687	1560	1638



OPTIONS

Description	Suffix	Models	Upcharge
Polished Aluminum Base	CH	6000	71
Seat Slider <i>(Can not combine with "AA")</i>	SL	6000	185
4 Way Arm Adjustment <i>(Can not combine with "SL")</i>	AA	6000	85
3" Carpet Casters	LG	6000	85
2" Hard Surface Casters	TC	6000	85
3" Hard Surface Casters	TC3	6000	149
Self-Locking Casters	LC	6000	78
Glides	GL	6000	85
Armless	07	6000, 6002	-50
Sit / Stand Drafting Stool	DS	6000	78

DIMENSIONS

Model	Overall Width	Overall Depth	Overall Height	Seat Height	Weight	Volume	KD Volume
6000	25.5"	24"	35.5"- 41"	16"- 21"	50 lbs	14 cu ft	9 cu ft
6002	25"	26"	35.25"	17.5"	41 lbs	13.25 cu ft	11.5 cu ft
6000-DS	25.5"	24"	41"- 49"	22"- 30"	50 lbs	14 cu ft	9 cu ft



The SXO™'s simple design and uber-cushioned Enersorb™ foam seat helps you concentrate on your work, free from aches and distractions.

STANDARD FEATURES

- ABLEX™ patterned mesh back provides generous lumbar support and dynamic back movement. Air flows freely through this breathable mesh for added comfort.
- Synchronous knee-tilt swivel mechanism with built-in seat slide depth adjuster, infinite position tilt-lock, pneumatic seat height adjustment and side tension control.
- Armrests move up/down, in/out, complete with lockable swivel pads.
- Energy absorbing dual density ENERSORB™ seat foam reduces sitting fatigue.
- Waterfall seat design that gently slopes away from the legs, minimizing pressure on the thighs and promoting good posture.
- Patented all-purpose back storage pocket built into the frame allows convenient storage for company mail or personal items.
- Black mesh with frame, arms, base and trim in graphite finish.
- 5-prong, heavy-duty nylon base.
- 2" carpet casters.
- ANSI/BIFMA approved and TB117-2013 compliant.

GENERAL INFORMATION

- Upholstery: 1 yd/chair
- Patented Design.



SXO™ 6100D

RATED FOR



SXO™ 6100-CH

Model	Description	1 Mystic	5 Beehive	6 Moguls	7 Meridian	Madras Leather	Princess Leather
6100	Mid Back	2026	2076	2217	2359	2359	2428
6100D	Mid Back with Headrest	2174	2224	2365	2507	2507	2577



OPTIONS

Description	Suffix	Models	Upcharge
3" Carpet Casters	LG	All Models	85
2" Hard Surface Casters	TC	All Models	85
3" Hard Surface Casters	TC3	All Models	149
Polished Aluminum Base	CH	All Models	71
Silver Mesh Back	SM	All Models	78
Armless	07	All Models	-50

DIMENSIONS

Model	Overall Width	Overall Depth	Overall Height	Seat Height	Weight	Volume	KD Volume
6100	27" - 29.5"	27"	37"- 42.5"	16"-21"	65 lbs	19 cu ft	16 cu ft
6100D	27" - 29.5"	27"	45.5"- 52"	16"-21"	70 lbs	19 cu ft	16 cu ft

The CXO™ is the most comfortable chair in the world. Enersorb™ foam seat and headrest, supportive mesh back, 4D adjustable lumbar support, and multi-adjustable arms are some of the features that make this our best-selling chair.

STANDARD FEATURES

- ABLEX™ patterned mesh back provides generous lumbar support and dynamic back movement.
- Easy to use, padded, 4D-adjustable arms with lockable vertical, horizontal, swivel, and front/back movement (6200D, 6200).
- Vertical and horizontal lumbar adjustment (6200D, 6200) .
- Synchronous knee-tilt swivel mechanism (6200D, 6200) with built-in seat slide depth adjuster, infinite position tilt-lock, pneumatic seat height adjustment and side tension control.
- Super soft, elongated polyurethane arm pads to help prevent Carpal Tunnel Syndrome.
- Headrest pivots horizontally and vertically on a contoured axis. Includes built in coat hook. (6200D).
- Energy absorbing, dual density ENERSORB™ seat foam reduces sitting fatigue.
- Contoured seat foam incorporates a waterfall design that gently slopes away from the legs, minimizing pressure on the thighs, promoting good posture.
- Contoured seat and back shell for ergonomic support.
- 5-prong die-cast aluminum base with anti-slip treads.
- 2" mag wheel carpet casters.
- Breathable 4-way stretch-knit fabric on seat, lumbar and headrest for improved air circulation.
- Black mesh with graphite frame, arms, base and trim.
- ANSI/BIFMA approved and TB117-2013 compliant.

GENERAL INFORMATION

- Upholstery: 2 yd/chair
- Patented Design.



CXO™ 6200D-TC

RATED FOR

350lbs



CXO™ 6200D-CH

Model	Description	1 Mystic	5 Beehave	6 Moguls	7 Meridian	Madras Leather	Princess Leather
6200	Mid Back	2753	2808	2817	2958	2958	3036
6200D	Mid Back with Headrest	2900	2954	2965	3105	3105	3183



6200

6200D

OPTIONS

Description	Suffix	Models	Upcharge
3" Carpet Casters	LG	6200, 6200D	85
2" Hard Surface Casters	TC	6200, 6200D	85
3" Hard Surface Casters	TC3	6200, 6200D	149
Polished Aluminum Package (Base, Arm Trim)	CH	6200, 6200D	71
Silver Mesh	SM	All Models	78
Non-Pivoting Arms	NP	6200, 6200D	163
Armless	07	6200, 6200D	-50
Original Style Headrest	OS	6200D	0
Upholstered Back	UPH	All Models	170

DIMENSIONS

Model	Overall Width	Overall Depth	Overall Height	Seat Height	Weight	Volume	KD Volume
6200	27" - 29.5"	27" - 29.5"	36.5" - 41.5"	16"-21"	75 lbs	19 cu ft	16 cu ft
6200D	27" - 29.5"	27" - 29.5"	47.5" - 55"	16"-21"	77 lbs	19 cu ft	16 cu ft



The CXO™ Leather takes the classic CXO™ and wraps it in the finest leather available, for an even more luxurious finish.

STANDARD FEATURES

- Seat, back, lumbar, and headrest upholstered in leather.
- Easy to use 4D-adjustable arms with lockable, finger-tip vertical, horizontal, swivel, and front/back movements for individual comfort (L6200D, L6200).
- Vertical and horizontal lumbar adjustment (L6200D, L6200).
- Synchronous knee-tilt swivel mechanism (L6200D, L6200) with built-in seat slide depth adjuster, infinite position tilt-lock, pneumatic seat height adjustment and side tension control.
- Super soft, elongated polyurethane arm pads to help prevent Carpal Tunnel Syndrome.
- Headrest pivots horizontally and vertically on a contoured axis. Includes built in coat hook. (6200D).
- Energy absorbing dual density ENERSORB™ seat foam reduces sitting fatigue.
- Contoured seat foam incorporates a “waterfall” design that gently slopes away from the legs, minimizing pressure on the thighs, promoting good posture.
- Contoured seat and back shell for ergonomic support.
- Graphite frame, arms, base and trim.
- 2” mag wheel carpet casters.
- 5-prong die-cast aluminum base with anti-slip treads.
- Intuitive easy grip side tension adjustment.
- ANSI/BIFMA approved and TB117-2013 compliant.

GENERAL INFORMATION

- Upholstery: 2 yd/chair
- Patented Design.



CXO™ L6200D-CH-TC

RATED FOR

350lbs



CXO™ L6200

Model	Description	Full Madras	Full Princess Leather
L6200	Mid Back	3276	3394
L6200D	Mid Back with Headrest	3501	3628



L6200



L6200D

OPTIONS

Description	Suffix	Models	Upcharge
3" Carpet Casters	LG	L6200, L6200D	85
2" Hard Surface Casters	TC	L6200, L6200D	85
3" Hard Surface Casters	TC3	L6200, L6200D	149
Polished Aluminum Package (<i>Base and Arm Trim</i>)	CH	L6200, L6200D	71
Heavy Duty	HD	L6200, L6200D	473
Non-Pivoting Arms	NP	L6200, L6200D	156
Armless	07	L6200, L6200D	-50
Original Style Headrest	OS	L6200D	0
Custom Embroidery*	EM	L6200D	227

*Standard charge for customer embroidery assumes an approved DST file will be provided at time of order placement. If a DST file needs to be created an additional \$300 list fee will apply. Note, there is a minimum order quantity of 8 units.

DIMENSIONS

Model	Overall Width	Overall Depth	Overall Height	Seat Height	Weight	Volume	KD Volume
L6200	27" - 29.5"	27"- 29.5"	36.5"- 41.5"	16"-21"	79 lbs	19 cu ft	16 cu ft
L6200D	27" - 29.5"	27"- 29.5"	47.5"- 55"	16"-21"	81 lbs	19 cu ft	16 cu ft



Still the most comfortable chair in the world, but engineered with greater strength and durability for weight demand up to 450 lbs.

STANDARD FEATURES

- ABLEX™ patterned mesh back provides generous lumbar support and dynamic back movement.
- Easy to use adjustable arms with lockable vertical and horizontal movements for individual comfort.
- Vertical and horizontal lumbar adjustment.
- Synchronous knee-tilt swivel mechanism (6200Dhd, 6200hd) with built-in seat slide depth adjuster, infinite position tilt-lock, pneumatic seat height adjustment and side tension control.
- Super soft, elongated polyurethane arm pads to help prevent Carpal Tunnel Syndrome.
- Headrest pivots horizontally and vertically on a contoured axis. Includes built in coat hook. (6200D).
- Energy absorbing dual density ENERSORB™ seat foam reduces sitting fatigue.
- Contoured seat foam incorporates a waterfall design that gently slopes away from the legs, minimizing pressure on the thighs, promoting good posture.
- Contoured seat and back shell for ergonomic support.
- 5-prong die-cast aluminum base.
- Breathable 4-way stretch-knit fabric on seat, lumbar and headrest for improved air circulation.
- Intuitive easy grip side tension adjustment.
- 3" carpet casters.
- Black mesh with graphite frame, arms, base and trim.
- Heavy duty class 4 gas lift.
- ANSI/BIFMA approved and TB117-2013 compliant.

GENERAL INFORMATION

- Upholstery: 2 yd/chair



CXO™ 6200Dhd-CH-TC3

RATED FOR

450lbs



CXO™ 6200Dhd-TC3

CXO™ HEAVY DUTY | 6200hd

Model	Description	1 Mystic	5 Beehave	6 Moguls	7 Meridian	Madras Leather	Princess Leather
6200hd	Mid Back Heavy Duty	3190	3232	3254	3394	3394	3466
6200Dhd	Mid Back Heavy Duty with Headrest	3338	3381	3402	3542	3542	3614



6200hd



6200Dhd

OPTIONS

Description	Suffix	Models	Upcharge
3" Hard Surface Casters	TC3	All Models	149
Polished Aluminum Base	CH	All Models	71
Silver Mesh Back	SM	All Models	78
Armless	07	All Models	-80
Original Style Headrest	OS	6200Dhd	0

DIMENSIONS

Model	Overall Width	Overall Depth	Overall Height	Seat Height	Weight	Volume	KD Volume
6200hd	27" - 29.5"	27" - 29.5"	36.5" - 41.5"	17.5" - 22"	95 lbs	19 cu ft	16 cu ft
6200Dhd	27" - 29.5"	27" - 29.5"	47.5" - 55"	17.5" - 22"	98 lbs	19 cu ft	16 cu ft



The most comfortable chair with reinforced supports, engineered for intensive use and 24hrs applications, for weights up to 350lbs.

STANDARD FEATURES

- ABLEX™ patterned mesh back provides generous lumbar support and dynamic back movement.
- Easy to use adjustable arms with lockable vertical and horizontal movements for individual comfort.
- Vertical and horizontal lumbar adjustment.
- Synchronous knee-tilt swivel mechanism (6200Dti, 6200ti) with built-in seat slide depth adjuster, infinite position tilt-lock, pneumatic seat height adjustment and side tension control.
- Super soft, elongated polyurethane arm pads over steel arm supports to help prevent Carpal Tunnel Syndrome.
- Headrest pivots horizontally and vertically on a contoured axis. Includes built in coat hook (6200D).
- Energy absorbing dual density ENERSORB™ seat foam reduces sitting fatigue.
- Contoured seat foam incorporates a waterfall design that gently slopes away from the legs, minimizing pressure on the thighs, promoting good posture.
- Heavy-duty class-4 gas lift.
- 5-prong die-cast aluminum base with anti-slip treads.
- Breathable 4-way stretch-knit fabric on seat, lumbar and headrest for improved air circulation.
- Intuitive easy grip side tension adjustment.
- Black mesh with graphite frame, arms, base and trim.
- 3" carpet casters.
- ANSI/BIFMA approved and TB117-2013 compliant.

GENERAL INFORMATION

- Upholstery: 1 yd/chair
- Patented Design.



CXO™ 6200Dti

RATED FOR

350lbs

3
SHIFTS
A DAY



CXO™ 6200Dti

CXO™ TASK INTENSIVE | 6200ti

Model	Description	1 Mystic	5 Beehave	6 Moguls	7 Meridian	Madras Leather	Princess Leather
6200ti	Mid Back Task Intensive	2998	3160	3063	3197	3204	3281
6200Dti	Mid Back Task Intensive with Headrest	3191	3190	3212	3347	3353	3431



6200ti



6200Dti

OPTIONS

Description	Suffix	Models	Upcharge
3" Hard Surface Casters	TC3	All Models	149
Polished Aluminum Base	CH	All Models	71
Silver Mesh	SM	All Models	78
Armless	07	All Models	-80
Original Style Headrest	OS	6200Dti	0

DIMENSIONS

Model	Overall Width	Overall Depth	Overall Height	Seat Height	Weight	Volume	KD Volume
6200	27" - 29.5"	27"- 29.5"	36.5"- 41.5"	16"-21"	84 lbs	19 cu ft	16 cu ft
6200D	27" - 29.5"	27"- 29.5"	47.5"- 55"	16"-21"	86 lbs	19 cu ft	16 cu ft



The GXO™ chair is designed to compliment the style and features of the XO™ executive chairs. Comfortable Enersorb™ seat, lumbar support, and mesh back provide a premium take on the conventional guest chair.

STANDARD FEATURES

- Translucent patterned, responsive ABLEX™ mesh back creates a contoured shape that provides perfect support for all users.
- Short arms provide comfortable support and easy access in and out of the chair. Polyurethane arm pads for comfort.
- Seat consists of a thin ultra-comfortable ENERSORB™ pillow-top layer of foam that allows for greater blood circulation, reducing seating pressure points and providing extreme comfort.
- Waterfall seat design that gently slopes away from the legs, minimizing pressure on the thighs and promoting good posture.
- Angled rear legs for stability.
- Black mesh with graphite back, legs and trim.
- Oval tubular reinforced steel legs, complete with adjustable non-marking floor glides.
- ANSI/BIFMA approved and TB117-2013 compliant.

GENERAL INFORMATION

- Upholstery: 1 yd/chair
- Patented Design.



GXO™ 6301



GXO™ 6301

Model	Description	1	2	3	4	5	6	7	8	Madras Leather	Princess Leather
6301	Side Chair	1159	1214	1263	1320	1376	1433	1488	1545	1440	1511



6301

OPTIONS

Description	Suffix	Models	Upcharge
Silver Mesh	SM	All Models	78

DIMENSIONS

Model	Overall Width	Overall Depth	Overall Height	Seat Height	Weight	Volume
6301	24"	26.5"	36"	18.5"	29lbs	11 cu ft



The NXO™ chair is a nesting, stacking, and storing chair that provides comfort, versatility, and style to any workplace. Available in classic or eye-catching colors, it is well-suited to any of your workspace needs.

STANDARD FEATURES

- Ergonomic support. Unique reclining motion of the back provides comfortable, relaxed support.
- Easy access. Folding seat allows the chair to nest horizontally, providing a smart storage solution.
- Seat consists of a ultra-comfortable ENERSORB™ foam that allows for greater blood circulation, reducing pressure points and providing extreme comfort.
- Space efficient. Vertical stacking capability of up to three chairs high provides even greater space efficient storage.
- Aeration. The perforated back with small holes enhances airflow and keeps the user cool and comfortable.
- Easy to move. Lightweight with durable casters.
- Frame, arms and trim standard in graphite.
- Light and clean aesthetic. Fits in without dominating the look or feel of the workspace.
- A visual companion to nontraditional work chairs, an ideal companion to the XO Collection of chairs.
- ANSI/BIFMA approved and TB117-2013 compliant.

GENERAL INFORMATION

- Upholstery: 1 yd/ chair
 - UF - 1½ yd/ chair
- Optional field installable fold away arm tablet available.
- Patented Design.



NXO™ 6401



NXO™ 6401-ATR

Model	Description	1	2	3	4	5	6	7	8	Madras Leather	Princess Leather
6401	Nesting Chair	881	939	1002	1058	1116	1173	1228	1285	1178	1248



6401

6401 M

Shown nested and stacked

OPTIONS

Description	Suffix	Models	Upcharge
Floor Glides	GL	All Models	85
2" Hard Surface Casters	TC	All Models	85
Armless	07	All Models	-20
Upholstered Back	UF	All Models	71
Fold Away Tablet with Arm (Left handed)	ATL	All Models	353
Fold Away Tablet with Arm (Right handed)	ATR	All Models	353
Chrome Legs	CH	All Models	78
Mesh Back	M	All Models	30

DIMENSIONS

Model	Overall Width	Overall Depth	Overall Height	Seat Height	Weight	Volume
6401	22.5"	24"	34"	17.5"	25 lbs	14.5 cu ft

The OXO™ side chair offers minimalist beauty, performance, and unprecedented comfort. Add a modern spark to any office or home with OXO™, which automatically adjusts to the user's movements to support good posture.

STANDARD FEATURES

- Translucent ABLEX™ mesh back and seat for perfect fit and customized support.
- Dynamic articulating back tilts with your body to provide exceptional ergonomic back and lumbar support.
- Generous seat size makes the OXO™ a very popular choice as it comfortably accommodates large and small users.
- Comfortable fixed polyurethane arm pads.
- Standard with glides.
- Easy to move. Lightweight and durable.
- Finish in black mesh with black back and seat shell.
- Frame is black epoxy powder coated.
- Waterfall seat design to reduce muscle fatigue.
- ANSI/BIFMA approved and TB117-2013 compliant.

GENERAL INFORMATION

- Leather Plus is not available.
- Patent Pending.



OXO™ 6501UFST



OXO™ 6502-WH

Model	Description	Mesh
6501	Four Legged with Arms Guest All Mesh	982
6502	Sled Base with Arms Guest All Mesh	1009



6501



6501-07



6502

OPTIONS

Description	Suffix	Models	Upcharge
Casters	CA	6501	85
White Package (White Seat and Back Shell, Chrome Frame, Silver Mesh)	WH	All Models	71
Armless	07	6501	-35
Upholstered Seat	UFST	All Models	Grade 1 - 161
Upholstered Seat	UFST	All Models	Grade 2 - 213
Upholstered Seat	UFST	All Models	Grade 3 - 264
Upholstered Seat	UFST	All Models	Grade 4 - 315
Upholstered Seat	UFST	All Models	Grade 5 - 373
Upholstered Seat	UFST	All Models	Madras Leather - 399

DIMENSIONS

Model	Overall Width	Overall Depth	Overall Height	Seat Height	Weight	Volume	KD Volume
6501	25.5"	26"	35.5"	18.5"	22 lbs	15 cu ft	N/A
6501-07	24"	26"	35.5"	18.5"	20 lbs	15 cu ft	N/A
6502	26"	26"	35.5"	18.5"	23 lbs	15 cu ft	N/A

The Bradley was designed to meet the rigorous demands of institutional and educational environments. Comfortable, versatile, and durable, it will exceed any of your workplace needs.

STANDARD FEATURES

- Swivel-tilt mechanism (Type 20) (6800D, 6800, 6850) seat depth adjustment, pneumatic height adjustment, tension control.
- Swivel mechanism (6800-DS) (Type 23) pneumatic height adjustment, seat depth adjustment.
- Waterfall seat design that gently slopes away from the legs minimizing pressure on the thighs, promoting good posture.
- Height-adjustable arms with tear drop polyurethane arm pads.
- Plastic back shell for durability and protection.
- High-density foam for support and durability.
- 5-prong, heavy-duty nylon base.
- 2" carpet casters.
- Mechanism, arms, base, trim, seat and back outer shell in black.
- ANSI/BIFMA approved and TB117-2013 compliant.

GENERAL INFORMATION

- Upholstery: 1 yd/chair
- If DS option selected, chair will not tilt.



Bradley 6800D

RATED FOR

300lbs



Bradley 6850-DS-07

Model	Description	1	2	3	4	5	6	7	8	Madras Leather	Princess Leather
6800D	High Back Task	1072	1136	1234	1298	1355	1412	1474	1539	1257	1398
6800	Mid Back Task	1002	1066	1164	1228	1285	1341	1404	1469	1187	1327
6850	Low Back Task	974	1037	1136	1200	1257	1313	1376	1440	1159	1298



6800D

6800

6850

6850-DS-07

OPTIONS

Description	Suffix	Models	Upcharge
3" Carpet Casters	LG	All Models	85
2" Hard Surface Casters	TC	All Models	85
3" Hard Surface Casters	TC3	All Models	149
Articulating Swivel Mechanism (Type 13)	AR	6800D, 6800, 6850	71
Swivel Multi-Tilt Mechanism (Type 17)	MT	All Models	92
Sit / Stand Drafting Stool	DS	All Models	63
Armless	07	All Models	-45

DIMENSIONS

Model	Overall Width	Overall Depth	Overall Height	Seat Height	Weight	Volume	KD Volume
6800D	24.5"	26"- 27.5"	36.5"- 45"	17.5"- 23"	46 lbs	17 cu ft	9.6 cu ft
6800	24.5"	26"- 27.5"	34"- 42"	17.5"- 23"	43 lbs	14 cu ft	9.6 cu ft
6850	24.5"	26"- 27.5"	31.5"- 39"	16"- 20"	43 lbs	12.5 cu ft	9.6 cu ft

Overtime

6800ti

The 6800ti accommodates individuals up to 350 lbs for 24hrs a day. It fits any budget and works perfectly in any busy, high-performance space.

STANDARD FEATURES

- Swivel tilt mechanism (Type 17A) with infinite position swivel tilt lock, free float or variable back angle adjustment, pneumatic seat height, back height adjustment and tension control.
- Built-in lumbar support.
- Heavy duty back post for durability.
- Heavy duty arms are attached directly to steel support under seat. Height and width adjustable arms for comfort and durability (6800ti).
- 5-prong, heavy-duty nylon base.
- Seat and back are made from high density, high resiliency foam for comfort and durability.
- Plastic back shell for durability and protection.
- Waterfall seat design gently slopes away from the legs, minimizing pressure on the thighs and promoting good posture.
- Mechanism, base, arms and trim in black finish.
- 6800Dti built stronger with larger seat.
- ANSI/BIFMA approved and TB117-2013 compliant.

GENERAL INFORMATION

- Upholstery: 1 yd/chair

6800Dti
RATED FOR

350lbs



Overtime 6800Dti

6800ti
RATED FOR

300lbs



Overtime 6800ti

Model	Description	1	2	3	4	5	6	7	8	Madras Leather	Princess Leather
6800ti	24hr Mid Back Task	1306	1341	1390	1447	1503	1553	1610	1665	1447	1539
6800Dti	24hr High Back Task	1679	1743	1841	1905	1962	2019	2081	2146	1855	1976



6800ti



6800Dti

OPTIONS

Description	Suffix	Models	Upcharge
2" Hard Surface Casters	TC	All Models	134
3" Carpet Casters	LG	All Models	134
3" Hard Surface Casters	TC3	All Models	149
Armless	07	All Models	-145
Fold Away Arms	FA	All Models	275

DIMENSIONS

Model	Overall Width	Overall Depth	Overall Height	Seat Height	Weight	Volume	KD Volume
6800ti	26" - 28"	26"	37" - 42.5"	16.5" - 22"	66 lbs	14 cu ft	9.6 cu ft
6800Dti	28" - 29.5"	26"	41" - 45.75"	16.5" - 22"	69 lbs	16 cu ft	9.6 cu ft

The Veronna is a stylish and colorful ergonomic executive task chair. It has a classic yet contemporary form and maximum ergonomic support that make it ideal for any office environment.

STANDARD FEATURES

- Smooth adjustments. Synchronous swivel-tilt mechanism with multi-position tilt-lock, pneumatic height adjustment, and tension control.
- Built-in integral seat slider, 2" adjustable seat depth. This adjustment allows the user to find the perfect seat depth for their height and size.
- Height adjustable arms pivot forward and backward, inside and outside, providing the necessary ergonomic support for the arms, shoulders and neck.
- Adjustable lumbar support pad with a 3" travel to provide support in the lower back.
- 5-prong, heavy-duty nylon base.
- 2" carpet casters.
- Waterfall seat design that gently slopes away from the legs, minimizing pressure on the thighs and promoting good posture.
- Energy absorbing dual density ENERSORB™ seat foam reduces sitting fatigue.
- ANSI/BIFMA approved and TB117-2013 compliant.

GENERAL INFORMATION

- Upholstery: 1.25 yd/chair



Veronna 7000-CH

RATED FOR

300lbs



Veronna 7000D

Model	Description	1	2	3	4	5	6	7	8	Madras Leather	Princess Leather
7000D	High Back Task Chair	1821	1878	1934	1992	2047	2104	2160	2217	2110	2181
7000	Mid Back Task Chair	1447	1497	1545	1595	1644	1695	1743	1793	1714	1785



7000D



7000

OPTIONS

Description	Suffix	Models	Upcharge
3" Carpet Casters	LG	All Models	85
2" Hard Surface Casters	TC	All Models	85
3" Hard Surface Casters	TC3	All Models	149
Partially Upholstered Back	UP	All Models	71
Polished Aluminum Base	CH	All Models	71
Armless	07	All Models	-70
Custom Embroidery*	EM	7000D	227

**Standard charge for customer embroidery assumes an approved DST file will be provided at time of order placement. If a DST file needs to be created an additional \$300 list fee will apply. Note, there is a minimum order quantity of 8 units.*

DIMENSIONS

Model	Overall Width	Overall Depth	Overall Height	Seat Height	Weight	Volume	KD Volume
7000D	26"- 27"	25"- 27"	46.5"- 54.25"	18"- 22.5"	56 lbs	17 cu ft	n/a
7000	26"- 27"	25"- 27"	39"- 43.5"	18"- 22.5"	47 lbs	17 cu ft	n/a

The VXO™ offers a simple, lightweight design that delivers remarkable comfort and dynamic support. Its easy to adjust lumbar support keeps you focused on what's at hand.

STANDARD FEATURES

- Swivel-tilt mechanism with single position lock, pneumatic height adjustment and side tension control.
- Height adjustable lumbar support pad.
- High density, high resiliency seat foam for comfort and durability.
- Adjustable arm height with comfortable polyurethane arm pads.
- 5-prong heavy duty nylon base.
- 2" carpet casters.
- Mesh, mechanism, arms, base and trim black.
- NEBULA™ mesh backing allows for comfortable air circulation and dynamic back movement.
- Waterfall seat design gently slopes away from the legs, minimizing pressure on the thighs and promoting good posture.
- ANSI/BIFMA approved and TB117-2013 compliant.

GENERAL INFORMATION

- Upholstery: 1 yd/chair
- If DS option selected, chair will not tilt.



VXO™ 7280-WH

RATED FOR



VXO™ 7280

Model	Description	1	2	3	4	5	6	7	8	Madras Leather	Princess Leather
7280	Mid Back Task	953	1009	1066	1121	1178	1234	1292	1347	1243	1313



7280



7280-L



7280-DS

OPTIONS

Description	Suffix	Models	Upcharge
3" Carpet Casters	LG	All Models	85
2" Hard Surface Casters	TC	All Models	85
3" Hard Surface Casters	TC3	All Models	149
Polished Aluminum Base	CH	All Models	71
Enersorb Foam Seat	E	All Models	106
Fixed Loop Arms	L	All Models	0
Sit / Stand Drafting Stool	DS	All Models	204
Multi Position Tilt Lock Mechanism	MT	All Models	185
Armless	07	All Models	-40
White Package (White Frame, Silver Mesh, Chrome Base, White Arms)	WH	All Models	176

DIMENSIONS

Model	Overall Width	Overall Depth	Overall Height	Seat Height	Weight	Volume	KD Volume
7280	24.5" - 25.5"	24.75"	35.25" - 40"	17"-22"	37 lbs	13 cu ft	11 cu ft
7280-DS	26" - 27"	26"	37.5" - 45.5"	20.5" - 28.5"	42 lbs	14 cu ft	11 cu ft



Perfectly balanced with smooth adjustments. IC2™ sets ergonomic and comfort standards that are second to none. Its curved, sleek design has been lauded by art specialists and users alike. It is lightweight, elegant, and functional.

STANDARD FEATURES

- Slow release synchronous knee tilt mechanism with dual-lever, integrated seat slide adjustment, pneumatic assist forward and recline adjustment, infinite tilt lock, pneumatic height adjustment and front tension control.
- NEBULA™ dual weave mesh back and seat allows air to pass freely, making it comfortable in all environments. It also boasts dynamic back movement.
- Headrest pivots in and out and adjusts up and down on a contoured axis.
- Leather-upholstered headrest.
- 5-prong, polished-aluminum base.
- 3" carpet casters.
- Upholstered seat models standard with ENERSORB™ seat foam.
- Dual-lever seat depth adjustment for those requiring more leg support.
- Arms are height, width, swivel, and forward/backward adjustable. Polyurethane arm pad for durability.
- The contoured polyurethane lumbar support pad can be height and depth adjusted for personalized comfort and support.
- ANSI/BIFMA approved and TB117-2013 compliant.

GENERAL INFORMATION

- Upholstery
 - UFST - 0.75 yd/chair
 - UF - 1.5 yd/chair
 - Headrest - 0.25 yd/chair
- When UF/UFST models are selected, headrest upholstery will be in the same selected textile, unless otherwise specified when ordering.



IC2™ 7300D-UFST-TC3

RATED FOR



IC2™ 7300D-UFST

Model	Description	Mesh	1	2	3	4	5	6	7	8	Madras Leather	Princess Leather
7300	Mid Back Task	1997										
7300UFST	Mid Back Task Upholstered Seat		2146	2181	2217	2258	2301	2344	2386	2428	2392	2470
7300UF	Mid Back Task Upholstered Seat and Back		2287	2321	2359	2400	2443	2485	2527	2569	2534	2683
7300D	Mid Back Task Adj. Headrest	2138										
7300D-UFST	Mid Back Task Adj. Headrest Upholstered Seat		2280	2316	2351	2392	2435	2479	2520	2563	2528	2604
7300D-UF	Mid Back Task Adj. Headrest Upholstered Seat and Back		2420	2457	2492	2533	2576	2618	2660	2703	2669	2816



OPTIONS

Description	Suffix	Models	Upcharge
3" Hard Surface Casters	TC3	All Models	149
White Package <i>(White Frame, Silver Mesh, Polished Aluminum Base)</i>	WH	All Models	141
Integrated Head Rest <i>Upholstered in black leather unless:</i> <ul style="list-style-type: none"> • <i>UF-selected textile</i> • <i>UFST-selected textile</i> • <i>WH madras steel is selected</i> 	INT	7300	141
Extra Thick Enersorb Seat Foam (2" Thick)	X	7300UF, 7300UFST, 7300DUF, 7300DUFST	71
Custom Embroidery*	EM	7300D, 7300DUFST, 7300DUF	227

*Standard charge for customer embroidery assumes an approved DST file will be provided at time of order placement. If a DST file needs to be created an additional \$300 list fee will apply. Note, there is a minimum order quantity of 8 units.

DIMENSIONS

Model	Overall Width	Overall Depth	Overall Height	Seat Height	Weight	Volume	KD Volume
7300	26" - 28"	26"	38" - 43"	16" - 20.5"	49 lbs	16 cu. ft.	N/A
7300D	26" - 28"	26"	45" - 52"	16" - 20.5"	51 lbs	16 cu. ft.	N/A
7300INT	26" - 28"	26"	45" - 48.5"	16" - 20.5"	51 lbs	16 cu. ft.	N/A



The Presider's smooth upholstery and thick-backed design provide an authoritative finish to office, conference, and meeting spaces. With its top-notch ergonomic support, the Presider is an outstanding chair with an affordable price tag.

STANDARD FEATURES

- ENERSORB™ seat and back foam conforms to your body and disperses your weight ergonomically to improve blood circulation and relieve pressure points.
- Synchronous knee-tilt mechanism with dual position tilt lock, pneumatic height adjustment, tension control.
- Height adjustable arms with polyurethane arm pads.
- 5-prong heavy duty nylon base.
- 2" carpet casters.
- Compound curved back for ergonomic comfort and support.
- Built-in lumbar support.
- Built-in head rest support (7700D).
- Mechanism, arms, base and trim in black finish.
- ANSI/BIFMA approved and TB117-2013 compliant.

GENERAL INFORMATION

- Upholstery: 3 yd/chair
- Pillow upholstery technique is used with vinyl, leather or leather plus to provide a wrinkled, plush appearance.



Presider 7700



Presider 7700D

Model	Description	1 Vinyl	4 Vinyl or Leather Plus	5 Vinyl	6 Vinyl	Madras Leather	Princess Leather
7700D	High Back Executive	1737	2154	2238	2407	2434	2724
7700	Mid Back Executive	1687	2104	2188	2357	2385	2674



Presider 7700D

OPTIONS

Description	Suffix	Models	Upcharge
3" Carpet Casters	LG	All Models	85
2" Hard Surface Casters	TC	All Models	85
3" Hard Surface Casters	TC3	All Models	149
Polished Aluminum Base & Arms (CXO Style without arm width adjustment)	CH	All Models	149
Armless	07	All Models	-70
Adjustable Lumbar Support	LU	All Models	141
Adjustable Seat Slider	SL	All Models	98
CXO Style Adjustable Arms (Graphite ONLY, without arm width adjustment)	A	All Models	71
Custom Embroidery*	EM	7700D	227

*Standard charge for customer embroidery assumes an approved DST file will be provided at time of order placement. If a DST file needs to be created an additional \$300 list fee will apply. Note, there is a minimum order quantity of 8 units.

DIMENSIONS

Model	Overall Width	Overall Depth	Overall Height	Seat Height	Weight	Volume	KD Volume
7700D	26"	27"	46"- 49"	17"- 21.5"	55 lbs	16 cu ft	N/A
7700	26"	27"	38"- 41"	17"- 21.5"	50 lbs	16 cu ft	N/A

The Manno is classic in appearance, yet modern in design. It has graceful, theatrical lines paired with undeniable comfort for an executive finish.

STANDARD FEATURES

- Synchro-tilt swivel mechanism, featuring slow-release, dual position tilt lock, pneumatic height adjustment, side tension control.
- Energy absorbing ENERSORB™ seat and back foam conforms to your body and disperses your weight ergonomically to improve blood circulation and relieve pressure points.
- Flex-Back, cantilevered, steel-reinforced frame (8672) finished in crinkle epoxy powder coat, electro-statically applied for corrosion resistance.
- Softly padded, upholstered arm pad (8600D, 8600).
- Contoured back for proper ergonomic support.
- Mechanism, arms, base and trim standard in black.
- 5-prong, heavy-duty nylon base.
- 2" Carpet casters.
- Waterfall seat design gently slopes away from the legs, minimizing pressure on the thighs and promoting good posture.
- ANSI/BIFMA approved and TB117-2013 compliant.

GENERAL INFORMATION

- Upholstery: 3 yd/chair
- Pillow upholstery technique is used with vinyl, leather or leather plus to provide a wrinkled, plush appearance.
- All wood upgrades are handcrafted and can add up to 30 days to lead time.



Manno 8600D



Manno 8600-CH

Model	Description	1 Vinyl	4 Vinyl or Leather Plus	5 Vinyl	6 Vinyl	Madras Leather	Princess Leather
8600D	High-Back Executive	2414	2795	2816	2979	2818	3276
8600	Mid-Back Executive	2316	2697	2717	2879	2957	3176
8672	Guest Cantilever	1695	2076	2095	2258	2336	2547



8600D



8600-CH



8672



8600D-WP-CY

OPTIONS

Description	Suffix	Models	Upcharge
3" Carpet Casters	LG	8600, 8600D	85
2" Hard Surface Casters	TC	8600, 8600D	85
3" Hard Surface Casters	TC3	8600, 8600D	149
Wood Base	WB	8600, 8600D	240
Polished Aluminum Base	CH	8600, 8600D	71
Wood Package (Wood Base Caps, Wood Arms)	WP	8600, 8600D	288
Wood Arm Caps	WC	8600, 8600D	149
Wood Stain Finishes	CY - Cherry • ME - Mellow Oak • NA - Natural MH - Mahogany • WL - Walnut	8600, 8600D	0
Custom Embroidery*	EM	8600D	227

**Standard charge for customer embroidery assumes an approved DST file will be provided at time of order placement. If a DST file needs to be created an additional \$300 list fee will apply. Note, there is a minimum order quantity of 8 units.*

DIMENSIONS

Model	Overall Width	Overall Depth	Overall Height	Seat Height	Weight	Volume	KD Volume
8600D	28"	27"	44.5" - 48.5"	18" - 22"	70 lbs	19 cu ft	16 cu ft
8600	26"	27"	40" - 44"	18" - 22"	66 lbs	17 cu ft	9.6 cu ft
8672	25.5"	25"	35"	17"	50 lbs	17 cu ft	17 cu ft

Sherman HD

HD9000

Sherman HD is designed for a 24-hour, 3-shift/day environment. The chair offers maximum comfort, support, and durability for active office spaces and users up to 450 lbs (350 lbs for the HD9000-DS).

STANDARD FEATURES

- Swivel tilt mechanism with infinite position tilt lock, seat depth adjustment, pneumatic height adjustment, and tension control.
- Built-in lumbar support.
- Reinforced steel seat with arms attached to bar for added strength.
- Swivel mechanism with pneumatic height adjustment and 2.5" seat depth adjustment (HD9000-DS).
- Oversized molded foam seat pan with a waterfall edge for greater comfort and to promote proper circulation. ENERSORB™ seat topper.
- Heavy duty steel fold-away arms that are height and width adjustable with ultra-comfortable polyurethane arm pads.
- Heavy duty height adjustable foot ring (HD9000DS).
- 28" 5-prong, structurally engineered aluminum base.
- 3" casters.
- ANSI/BIFMA approved and TB117-2013 compliant.

GENERAL INFORMATION

- Upholstery: 3 yd/chair

HD9000
RATED FOR

450lbs



Sherman HD9000

HD9000-DS
RATED FOR

350lbs



Sherman HD9000-DS

SHERMAN HD | HD9000

Model	Description	1	2	3	4	5	6	7	8	Madras Leather	Princess Leather
HD9000	Heavy Duty Task Chair with Fold Away Arms	2110	2195	2280	2364	2448	2533	2618	2703	2547	2688



HD9000



HD9000-DS

OPTIONS

Description	Suffix	Models	Upcharge
3" Hard Surface Casters	TC3	All Models	149
Armless	07	All Models	-155
Sit / Stand Drafting Stool	DS	All Models	0

DIMENSIONS

Model	Overall Width	Overall Depth	Overall Height	Seat Height	Weight	Volume	KD Volume
HD9000	27" - 30"	26.5"	41.5" - 47"	17" - 21.5"	92.4 lbs	17.18 cu ft	13.58 cu ft
HD9000DS	27" - 30"	26.5"	44" - 52"	23" - 31"	90 lbs	17.18 cu ft	13.58 cu ft

LIFETIME LIMITED WARRANTY

The Lifetime Limited Warranty applies only for **NIGHTINGALE** products listed herein, and manufactured after January 1st, 2018, and applies to products delivered to customers in Canada and the United States of America.

Under the **NIGHTINGALE** Warranty, all claims must be made within the time period specified herein.

This Warranty begins with the date of purchase from the Nightingale Dealer by the original purchaser, and applies as follows:

- Lifetime Limited: all non-moving metal parts.
- 10 Years: Control mechanisms, casters, pneumatic cylinders, self-skinned urethane parts, and plastic shells.
- 5 Years: Upholsteries.

The **NIGHTINGALE** Warranty is based on normal use within a normal commercial office setting of single shift, eight (8) hours per day, five (5) days per week, by individuals of 275 lbs or less.

Some natural variations occurring in wood, leather, or other natural materials are inherent to their character and are not considered defects. Nightingale Corp. does not warrant the colorfastness or matching of colors, grains, or textures of these materials. Additionally, a Customer's Own Material (COM) selected by, and used at the request of, a customer, is not warranted.

The Warranty does not apply to:

- Normal wear and tear over the course of ownership.
- Damage caused by abuse, misuse, accident, or negligence.
- Abnormal use or use within extreme climatic conditions. Normal climatic condition is defined as the temperature and moisture content range for human comfort and health.
- Alterations to or modifications of the product not approved by Nightingale Corp.
- Products not installed, used, or maintained in accordance with product instructions and warnings.
- Products used for rental purposes; and,
- Damage caused by the carrier-in-transit, which is handled under separate terms.

Compliance with applicable laws, regular codes, certificates, and manufacturing standards are disclaimed if this product is misused, improperly installed, or modified in any respect (including without limitation, any change in fabric or mechanical components affecting stability, load capacity, or load distribution) after shipment from Nightingale Corp.

The **NIGHTINGALE** Warranty does not cover the cost of transportation or labor, except as noted.

All Warranty claims must be submitted by the Nightingale Dealer that sold the product.

Nightingale Corp. reserves the exclusive and sole right to determine whether a **NIGHTINGALE** seating product is defective in material or workmanship.

In order for Nightingale Corp. to determine whether the Warranty applies, the following information must be supplied to Nightingale Customer Care:

- Original Purchase Order and Purchase Order Date.
- Nightingale Corp. Invoice Number and Invoice Date.
- Product Model Number.
- Reason for claim.
- Please note that Nightingale Corp. may also require that photographs be supplied, clearly depicting the defective part or product. Nightingale reserves the right to deny any Warranty claim that does not include photographs when requested.

Should a Warranty claim be approved by Nightingale, then Nightingale will issue a Warranty Ticket Number to that claim. Nightingale Corp. will then, at its exclusive and sole discretion, apply one of the following remedies:

1. Issue replacement parts only, at no charge and prepaid freight. The cost of transportation and labor is not covered.

or
2. On a **discretionary basis**, Nightingale may determine that replacement parts and more significant labor may be required. Nightingale may authorize the Dealer to carry out the repair either directly or via a bona fide third party approved by Nightingale. All Warranty claims are evaluated on a case by case basis. The following conditions apply:
 - No service work can be performed without prior written approval by an authorized Nightingale Corp. employee.
 - The Warranty policy does not apply to Damage Claims, which are processed separately. Please refer to the Terms and Conditions outlined in the current **NIGHTINGALE** price book, regarding Freight Damage.
 - Nightingale Corp. will only deal with the Dealer directly. Nightingale will not deal with any third party or end user.

LIFETIME LIMITED WARRANTY

- In order for approval to be given, the Dealer must submit a pro-forma invoice or quotation, based on the average hourly labor rate assigned by Nightingale Corp., as stated below. Once approved, an authorized Nightingale employee will provide written consent to proceed.
- The Warranty Ticket Number issued upon approval must be indicated on the pro-forma invoice or quotation.
- If the Dealer chooses to outsource service work to a bona fide third party, then the Dealer must provide a bona-fide invoice or quotation from the third party.
- For the purposes of the Warranty, Nightingale Corp. has assigned an average hourly wage rate of \$20/hr based on data provided by the Bureau of Labor Statistics (BLS) in the United States, and Statistics Canada (StatsCan) in Canada. Nightingale Corp. will not apply any amount greater than this. Nightingale Corp. reserves the right to adjust the rate without notice.
- Transportation time for only one employee will be reimbursed unless it is necessary for more than one service technician to perform the service. Transportation costs must be supplied with the pro-forma invoice or quotation. Nightingale Corp. reserves the right to decline submissions for transportation costs, if they are not within reason. Feedback will be provided with any declined submissions so that the request can be re-adjusted and re-submitted.
- All replacement parts will ship with an assigned Nightingale Acknowledgment Number.
- After service work is performed, the Dealer must submit an invoice. The assigned Warranty Ticket Number and the Acknowledgment Number for the replacement parts must be included on the invoice. Nightingale Corp. will not reimburse any amount greater than the amount provided in the pro-forma invoice or quotation.
- Nightingale Corp. will not reimburse for any service work performed on **NIGHTINGALE** product without prior written consent from Nightingale.

Over and above the description of the claim and any photographs supplied, Nightingale Corp may require that the defective part be returned collect. Nightingale reserves the right to charge for a replacement part, if a defective part is determined to not be covered under Warranty.

Warranty Exception:

- 247-HD, and Sherman (except HD9000DS which is rated to 350lbs only) is warranted for multiple shifts and users up to 450 lbs. Multiple shifts is defined as three (3) shifts, twenty-four (24) hours per day, seven (7) days per week.
- Weight capacity for all task seating only (Legacy, Ergo-Learn, Ultima II, Bless, Frio, EC1, EC2, EC3, EC5, EC6, WXO, LXO, Bradley, Verona, VXO, IC2, Dany) is increased to 300lbs.
- Weight capacity for CXO, NLC and SXO series is increased to 350lbs.
- CXO-TI ("Task Intensive") and HD6800D is warranted for multiple shifts and users up to 350 lbs.
- CXO-HD is warranted for single shifts and users up to 450 lbs.
- Overtime is warranted for multiple shifts and users up to 300 lbs. Multiple shifts is defined as three (3) shifts, twenty-four (24) hours per day, seven (7) days per week.
- Nightingale Corp. warrants that the Nightingale products listed above are covered under the Nightingale General Warranty, as stated above. Due to the special application of these products, the following specific Warranty applies:
The Following Warranty Exception applies to 24hr Rated Items Only
- Lifetime: all non-moving metal components.
- 5 years: Heavy-duty control mechanisms, casters, pneumatic cylinders, self-skinned urethane parts, and plastic shells.
- 2 year: Upholsteries.

Nightingale Corp. offers no other warranty, either expressed or implied, including any warranty of merchantability or fitness for a particular purpose. Nightingale Corp. shall not be liable for consequential or incidental damages arising from any product defect.



GLOSSARY OF ABBREVIATIONS

SUFFIX	DESCRIPTION
04	Four Prong Base
07	Armless
A	Height Adjustable Arms
AA	4 Way Adjustable Arms - Height & Width
ATL	Left Handed Tablet
ATR	Right Handed Tablet
AR	Articulating Swivel Mechanism
BA	Back Angle Mechanism
BL	Black
BRK	Braking Casters
CA	Carpet Casters
CH	Chrome
CY	Cherry Stain
DS	Drafting Stool
DT	Dual Tone Upholstery
E	Enersorb Foam
EL	Electrical Outlet
EM	Custom Embroidery
FP	Four Prong Base
GANG	Ganging Guide
GL	Glides
GHG	Ganging Glide
GSN	Soft Plastic Glide
GHN	Hard Plastic Glide
GW	Ganging Welded Wire Hook
HA	Height Adjustable Arms & Lever Operated Width
HD	Heavy Duty
K	Knee-tilt Swivel Mechanism

SUFFIX	DESCRIPTION
L	Fixed Loop Arm
LC	Self Locking Caster (When Standing)
LG	3" Carpet Caster
LH	Left Handed
LU	Adjustable Lumbar Support
ME	Mellow Oak Stain
MF	Modern-Flair Arm Option
MH	Mahogany Stain
ML	Auto Return Gas Lift
MT	Multi Position Tilt Lock
NA	Natural Wood Stain
OS	Original Style Headrest
RD	Rolled Arm Option
RH	Right Handed
RLC	Self Locking Caster (When Sitting)
SL	Seat Sliding Mechanism
SM	Silver Mesh
TC3	3" Hard Surface Casters
TC	2" Hard Surface Casters
TL	Swivel-Tilt Lock Mechanism
UC	Upholstered Arm Caps
UF	Upholstered Seat and Back
UFST	Upholstered Seat
UPH	Upholstered Back
UR	Urethane Arms
WB	Wire Storage Basket (300 Series Only)
WB	Wood Base (8600 Series)
A	CXO Style Arms (Graphite Only) without arm width adjustment
X	Extra Thick Enersorb Seat Foam

ECOLOGICAL STATEMENT

Our mission is to reduce our carbon footprint however, wherever, and whenever we can.

We strive to build chairs that serve people and the planet and make the world a greener place. This is just one of the many ways that Nightingale puts purpose before profit, always.

At Nightingale Corp., we believe in respecting our employees, our customers, our vendors, and the environment. By respecting our planet's fragile ecosystem, we respect our children's future, their children's future...

Planet Nightingale is our environmental initiative. Our commitment to the environment is expressed in a variety of ways – from making smart choices when it comes to choosing materials and processes, to designing products that are simple, flexible, and durable. It's all about doing more with less.

Nightingale is proud to have developed and promoted an environmental policy long before government instituted mandatory recycling. We are committed to manufacturing our products utilizing methods and materials that help to reduce the adverse impact on our environment.

The basic elements of our plan are to use others' waste (recycled materials) or sustainable sources of raw materials to create our products, to ensure that our products are recyclable, to use as few resources as possible in the manufacturing process, and to ensure that we minimize or eliminate waste and emissions.

ISO 14001 & ISO 9001 CERTIFIED
TB117-2013 COMPLIANT

Made in a 100% waste free manufacturing facility.



DIMENSIONS DISCLAIMER

Dimensions are subject to change without notice.
Dimensions may have a variance of up to 0.5".
Contact Nightingale if more precise measurements are needed.

TEXTILE DISCLAIMER

Nightingale only upholsters with top quality materials.

Nightingale recommends ordering product samples at www.nightingalechairs.com/textiles before final purchase to get a more accurate representation of color. However, due to slight variations in dye lots, there can be slight color variations to received product.

Nightingale has made every effort to represent the colors and textures of these textiles, vinyls and leathers as accurately as possible. However, we cannot guarantee 100% accuracy, due to variations that occur in the printing process.



nightingalechairs.com

800 363 8954